

FOR SALE

# FREESTANDING INDUSTRIAL WAREHOUSE

1202 8A Street, Nisku, AB

20,838 SF WITH DRIVE AROUND ACCESS



**CUSHMAN & WAKEFIELD**  
Edmonton  
Suite 2700, TD Tower  
10088 - 102 Avenue  
Edmonton, AB T5J 2Z1  
[www.cwedm.com](http://www.cwedm.com)

**Adrian Ambrozuk**  
Associate Partner  
780 733 6406  
[adrian.ambrozuk@cwedm.com](mailto:adrian.ambrozuk@cwedm.com)

**Zeshan Qureshi CPA, CA**  
Partner  
780 238 4576  
[zeshan.qureshi@cwedm.com](mailto:zeshan.qureshi@cwedm.com)

**Jack Norris**  
Associate  
587 635 1897  
[jack.norris@cwedm.com](mailto:jack.norris@cwedm.com)

 **CUSHMAN &  
WAKEFIELD**  
Edmonton

Cushman & Wakefield Edmonton is independently owned and operated / A Member of the Cushman & Wakefield Alliance. No warranty or representation, express or implied, is made to the accuracy or completeness of the information contained herein, and same is submitted subject to errors, omissions, change of price/rental or other conditions, withdrawal without notice, and to any special listing conditions imposed by the property owner(s). As applicable, we make no representation as to the condition of the property (or properties) in question. May, 2026

# THE OPPORTUNITY

- Rare opportunity to own a  $\pm 20,838$  SF freestanding industrial warehouse.
- Drive around access, w/ two site access points
- Fully fenced, gated and secured site
- Crane capable
- Heavy power

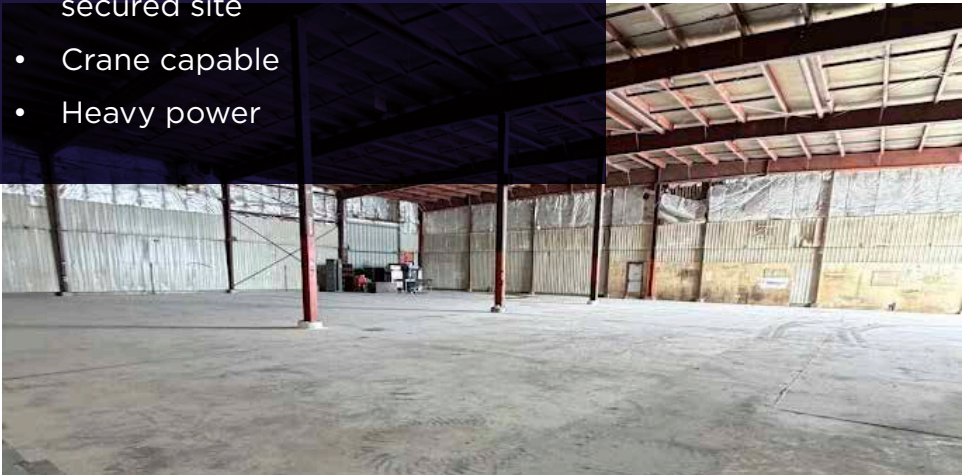

# FLOOR PLAN

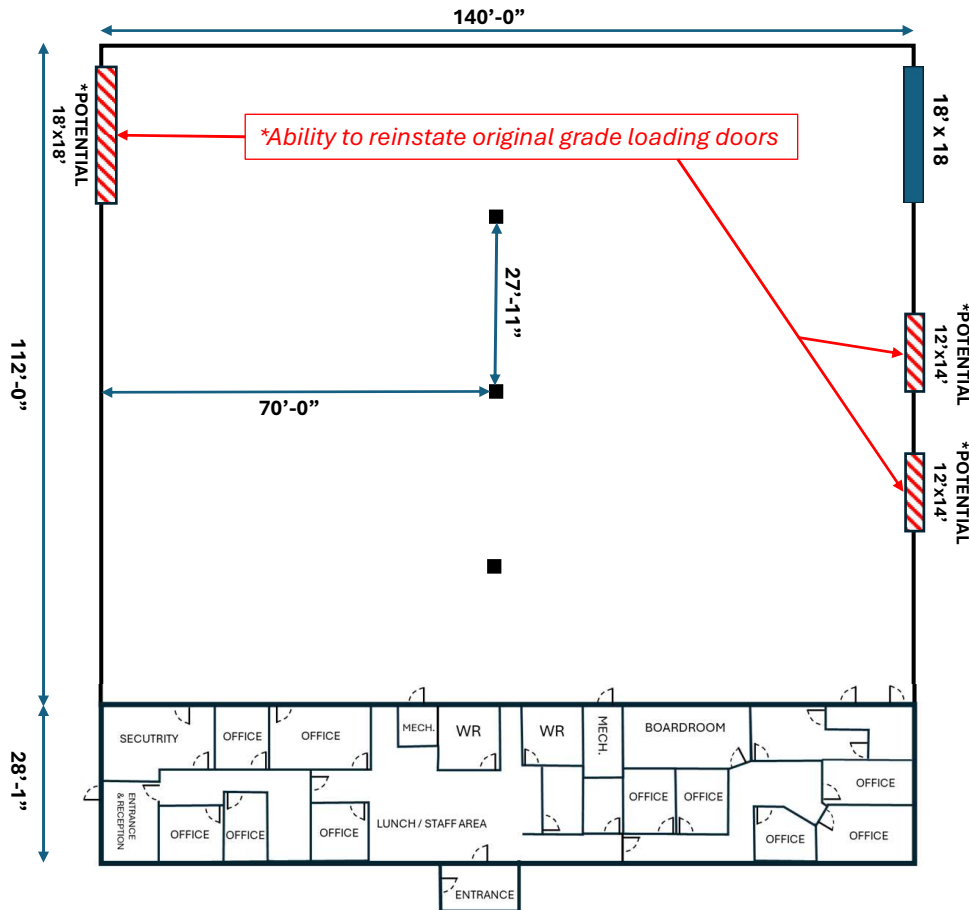

**\*\*MEASUREMENTS ARE NOT TO SCALE AND MUST BE VERIFIED BY A PROFESSIONAL FOR ACCURACY\*\***

# PROPERTY DETAILS

## MUNICIPAL ADDRESS

1202 8A Street, Nisku AB

## LEGAL DESCRIPTION

Plan 7821344, Block 14, Lot 3

## ZONING

IND - Industrial

## SITE SIZE

1.26 Acres

## SITE COVERAGE RATIO

37%

## BUILDING AREA

4,948 SF - Office Area

15,890 SF - Warehouse

20,838 SF - Total

## POWER

Heavy power, 3 phase (TBV)

## LOADING DOORS

(1) 18'x18' Grade

(1) 18'x18' Grade\*

(2) 12'x14' Grade\*

\*Ability to reinstate original grade loading doors

## AVAILABILITY

Immediately

## CLEAR HEIGHT

20' clear in warehouse

# SALE PRICE

**\$3,250,000.00**

# KEEP IN TOUCH



**CUSHMAN & WAKEFIELD**  
Edmonton  
Suite 2700, TD Tower  
10088 - 102 Avenue  
Edmonton, AB T5J 2Z1  
[www.cwedm.com](http://www.cwedm.com)

**Adrian Ambrozuk**  
Associate Partner  
780 733 6406  
[adrian.ambrozuk@cwedm.com](mailto:adrian.ambrozuk@cwedm.com)

**Zeshan Qureshi CPA, CA**  
Partner  
780 238 4576  
[zeshan.qureshi@cwedm.com](mailto:zeshan.qureshi@cwedm.com)

**Jack Norris**  
Associate  
587 635 1897  
[jack.norris@cwedm.com](mailto:jack.norris@cwedm.com)

Cushman & Wakefield Edmonton is independently owned and operated / A Member of the Cushman & Wakefield Alliance. No warranty or representation, express or implied, is made to the accuracy or completeness of the information contained herein, and same is submitted subject to errors, omissions, change of price, rental or other conditions, withdrawal without notice, and to any special listing conditions imposed by the property owner(s). As applicable, we make no representation as to the condition of the property (or properties) in question.  
May, 2026