



**CUSHMAN &
WAKEFIELD**
Edmonton

FOR LEASE

84 AVENUE INDUSTRIAL BAYS

3909 84 Avenue, Leduc, AB



EXTENSIVE YARD UPGRADES

NEW OFFICE RENOVATIONS

TWO (2) 3,600 SF INDUSTRIAL BAYS FOR LEASE

PROPERTY HIGHLIGHTS

- Two (2) bays of 3,600 SF available (non contiguous)
- Concrete yard and drive aisles
- Office upgrades including paint, flooring, LED lighting
- Sump in the warehouse
- Adjacent to Nisku Industrial Park, with quick access to QEII Highway via Airport Road, and 5 minutes to the Edmonton International Airport
- Large marshalling and exclusive yard area
- Available June 1, 2024

Kennedy Munro

Associate

780 670 3042

kennedy.munro@cwedm.com

Chris Sieben

Partner

780 720 0227

chris.sieben@cwedm.com

Zeshan Qureshi CPA, CA

Partner

780 238 4576

zeshan.qureshi@cwedm.com

CUSHMAN & WAKEFIELD Edmonton

Suite 2700, TD Tower
10088 - 102 Avenue
Edmonton, AB T5J 2Z1

www.cwedm.com

Cushman & Wakefield Edmonton is independently owned and operated / A Member of the Cushman & Wakefield Alliance. No warranty or representation, express or implied, is made to the accuracy or completeness of the information contained herein, and same is submitted subject to errors, omissions, change of price, rental or other conditions, withdrawal without notice, and to any special listing conditions imposed by the property owner(s). As applicable, we make no representation as to the condition of the property (or properties) in question. January 12, 2024

PROPERTY DETAILS

Neighbourhood:	Leduc Business Park	Ceiling Height:	24' clear
Zoning:	IM - Medium Industrial	Lease Rate:	\$13.00 per SF
Space Size:	3,600 SF	Operating Costs:	\$4.75 per SF (2024)
Loading Doors:	One (1) 12'x14' grade door/ bay	Availability:	June 1, 2024
Power Service:	208 Volt, 200 Amp, 3 Phase/ bay (TBC by the Tenant)		

AERIAL



PROPERTY PHOTO



FLOOR PLAN

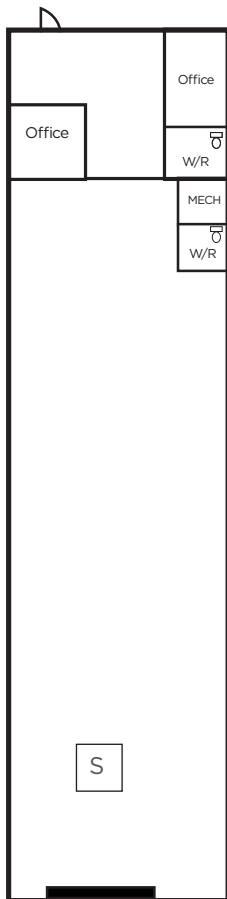

* Sample floor plan

SITE PLAN

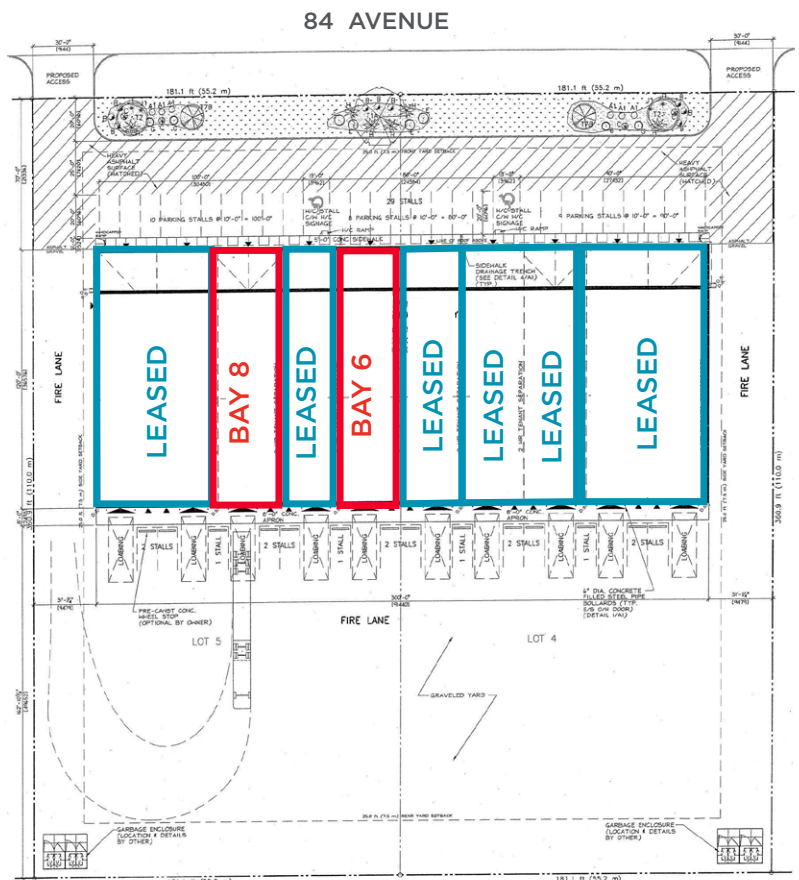



**CUSHMAN &
WAKEFIELD**
Edmonton

Kennedy Munro

Associate

780 670 3042

kennedy.munro@cwedm.com

Chris Sieben

Partner

780 720 0227

chris.sieben@cwedm.com

Zeshan Qureshi CPA, CA

Partner

780 238 4576

zeshan.qureshi@cwedm.com