



**CUSHMAN &
WAKEFIELD**
Edmonton

ONLY ONE BAY REMAINING

FOR LEASE

84 AVENUE INDUSTRIAL BAYS

3909 84 Avenue, Leduc, AB



EXTENSIVE YARD UPGRADES

NEW OFFICE RENOVATIONS

3,600 SF INDUSTRIAL BAY FOR LEASE

PROPERTY HIGHLIGHTS

- One (1) 3,600 SF industrial bay
- Concrete yard and drive aisles
- Office upgrades including paint, flooring, LED lighting
- Sump in the warehouse
- Adjacent to Nisku Industrial Park, with quick access to QEII Highway via Airport Road, and 5 minutes to the Edmonton International Airport
- Large marshalling and exclusive yard area
- Available immediately

Mark Bowman

Associate

780 702 4256

mark.bowman@cwedm.com

Chris Sieben

Partner

780 720 0227

chris.sieben@cwedm.com

Zeshan Qureshi CPA, CA

Partner

780 238 4576

zeshan.qureshi@cwedm.com

**CUSHMAN & WAKEFIELD
Edmonton**

Suite 2700, TD Tower

10088 - 102 Avenue

Edmonton, AB T5J 2Z1

www.cwedm.com

Cushman & Wakefield Edmonton is independently owned and operated / A Member of the Cushman & Wakefield Alliance. No warranty or representation, express or implied, is made to the accuracy or completeness of the information contained herein, and same is submitted subject to errors, omissions, change of price, rental or other conditions, withdrawal without notice, and to any special listing conditions imposed by the property owner(s). As applicable, we make no representation as to the condition of the property (or properties) in question. Jan. 17, 2025

PROPERTY DETAILS

Neighbourhood:	Leduc Business Park
Zoning:	IL - Light Industrial
Space Size:	3,600 SF
Loading Doors:	One (1) 12'x14' grade door
Power Service:	208 Volt, 200 Amp, 3 Phase/ bay (TBC by the Tenant)

Ceiling Height:	24' clear
Lease Rate:	Starting at \$13.00 per SF
Operating Costs:	\$4.75 per SF (2025)
Availability:	Immediately

AERIAL



PROPERTY PHOTO



FLOOR PLAN

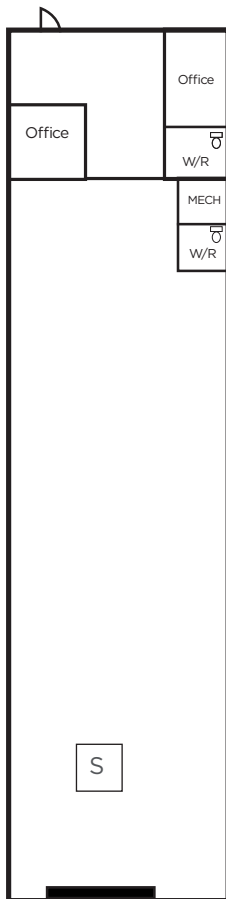

* Sample floor plan for 3,600 SF

SITE PLAN

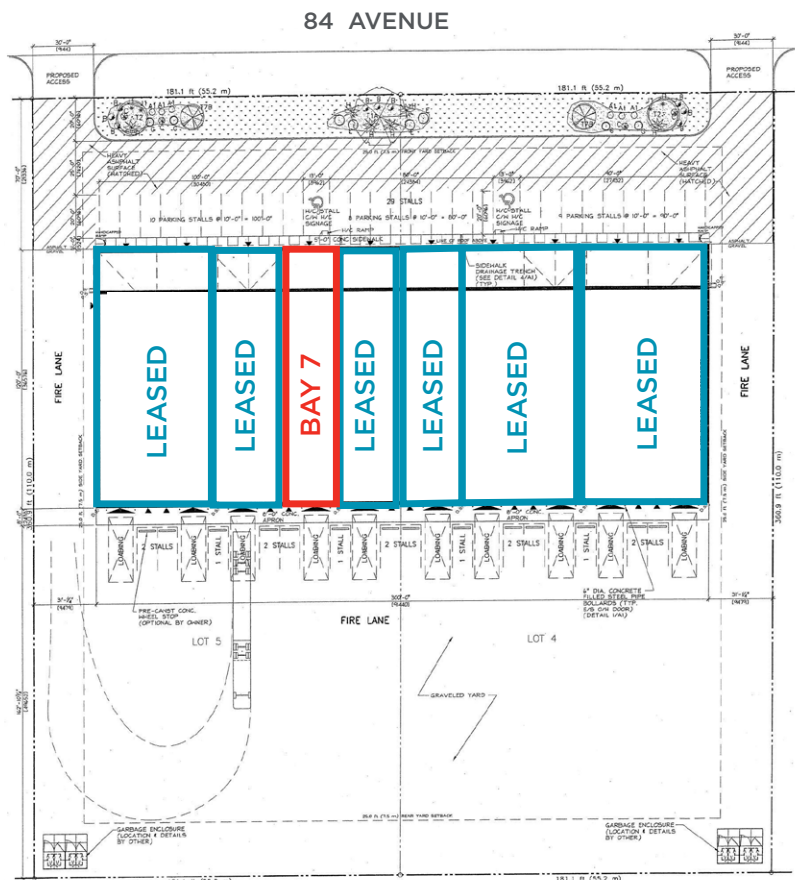



**CUSHMAN &
WAKEFIELD**
Edmonton

Mark Bowman
Associate
780 702 4256
mark.bowman@cwedm.com

Chris Sieben
Partner
780 720 0227
chris.sieben@cwedm.com

Zeshan Qureshi CPA, CA
Partner
780 238 4576
zeshan.qureshi@cwedm.com