



**CUSHMAN &  
WAKEFIELD**  
Edmonton

FOR LEASE

## 84 AVENUE INDUSTRIAL BAYS

3909 84 Avenue, Leduc, AB

ONLY ONE BAY REMAINING



EXTENSIVE YARD UPGRADES

NEW OFFICE RENOVATIONS

### 3,600 SF INDUSTRIAL BAY FOR LEASE

#### PROPERTY HIGHLIGHTS

- One (1) 3,600 SF industrial bay
- Concrete yard and drive aisles
- Office upgrades including paint, flooring, LED lighting
- Sump in the warehouse
- Adjacent to Nisku Industrial Park, with quick access to QEII Highway via Airport Road, and 5 minutes to the Edmonton International Airport
- Large marshalling and exclusive yard area
- Available immediately

**Mark Bowman**

Associate

780 702 4256

[mark.bowman@cwedm.com](mailto:mark.bowman@cwedm.com)

**Chris Sieben**

Partner

780 720 0227

[chris.sieben@cwedm.com](mailto:chris.sieben@cwedm.com)

**Zeshan Qureshi** CPA, CA

Partner

780 238 4576

[zeshan.qureshi@cwedm.com](mailto:zeshan.qureshi@cwedm.com)

**CUSHMAN & WAKEFIELD  
Edmonton**

Suite 2700, TD Tower

10088 - 102 Avenue

Edmonton, AB T5J 2Z1

[www.cwedm.com](http://www.cwedm.com)

Cushman & Wakefield Edmonton is independently owned and operated / A Member of the Cushman & Wakefield Alliance. No warranty or representation, express or implied, is made to the accuracy or completeness of the information contained herein, and same is submitted subject to errors, omissions, change of price, rental or other conditions, withdrawal without notice, and to any special listing conditions imposed by the property owner(s). As applicable, we make no representation as to the condition of the property (or properties) in question. November, 2024

# PROPERTY DETAILS

Neighbourhood:	Leduc Business Park
Zoning:	IM - Medium Industrial
Space Size:	3,600 SF
Loading Doors:	One (1) 12'x14' grade door
Power Service:	208 Volt, 200 Amp, 3 Phase/ bay (TBC by the Tenant)

Ceiling Height:	24' clear
Lease Rate:	Starting at \$13.00 per SF
Operating Costs:	\$4.75 per SF (2024)
Availability:	Immediately

## AERIAL



# PROPERTY PHOTO



# FLOOR PLAN

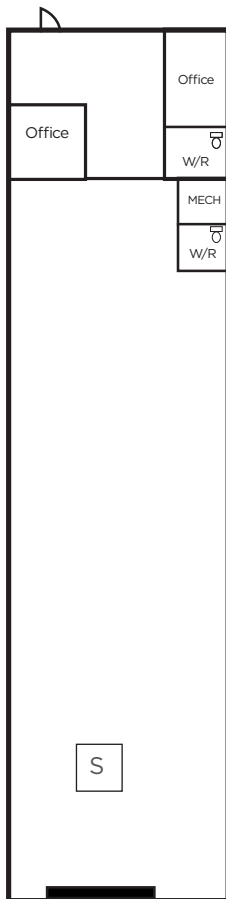

\* Sample floor plan for 3,600 SF

# SITE PLAN

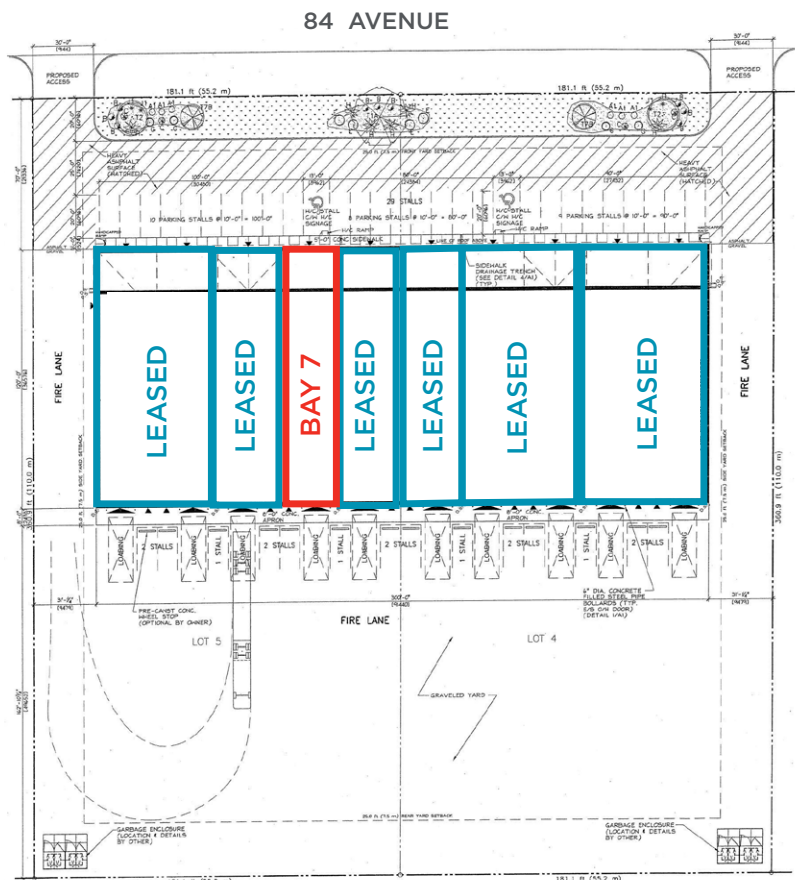



**CUSHMAN &  
WAKEFIELD**  
Edmonton

**Mark Bowman**  
Associate  
780 702 4256  
[mark.bowman@cwedm.com](mailto:mark.bowman@cwedm.com)

**Chris Sieben**  
Partner  
780 720 0227  
[chris.sieben@cwedm.com](mailto:chris.sieben@cwedm.com)

**Zeshan Qureshi** CPA, CA  
Partner  
780 238 4576  
[zeshan.qureshi@cwedm.com](mailto:zeshan.qureshi@cwedm.com)