



**CUSHMAN &
WAKEFIELD**
Edmonton

FOR LEASE

84 AVENUE INDUSTRIAL BAYS

3909 84 Avenue, Leduc, AB



EXTENSIVE YARD UPGRADES

NEW OFFICE RENOVATIONS

3,600 – 7,200 SF INDUSTRIAL BAYS FOR LEASE

PROPERTY HIGHLIGHTS

- Two (2) bays of 3,600 SF available (contiguous)
- Concrete yard and drive aisles
- Office upgrades including paint, flooring, LED lighting
- Sump in the warehouse
- Adjacent to Nisku Industrial Park, with quick access to QEII Highway via Airport Road, and 5 minutes to the Edmonton International Airport
- Large marshalling and exclusive yard area
- Available immediately

Mark Bowman

Associate

780 702 4256

mark.bowman@cwedm.com

Chris Sieben

Partner

780 720 0227

chris.sieben@cwedm.com

Zeshan Qureshi CPA, CA

Partner

780 238 4576

zeshan.qureshi@cwedm.com

**CUSHMAN & WAKEFIELD
Edmonton**

Suite 2700, TD Tower
10088 - 102 Avenue
Edmonton, AB T5J 2Z1

www.cwedm.com

Cushman & Wakefield Edmonton is independently owned and operated / A Member of the Cushman & Wakefield Alliance. No warranty or representation, express or implied, is made to the accuracy or completeness of the information contained herein, and same is submitted subject to errors, omissions, change of price, rental or other conditions, withdrawal without notice, and to any special listing conditions imposed by the property owner(s). As applicable, we make no representation as to the condition of the property (or properties) in question. June 3, 2024

PROPERTY DETAILS

| | | | |
|----------------|--|------------------|----------------------------|
| Neighbourhood: | Leduc Business Park | Ceiling Height: | 24' clear |
| Zoning: | IM - Medium Industrial | Lease Rate: | Starting at \$13.00 per SF |
| Space Size: | 3,600 - 7,200 SF | Operating Costs: | \$4.75 per SF (2024) |
| Loading Doors: | One (1) 12'x14' grade door/ bay | Availability: | Immediately |
| Power Service: | 208 Volt, 200 Amp, 3 Phase/ bay (TBC by the Tenant) | | |

AERIAL



PROPERTY PHOTO



FLOOR PLAN

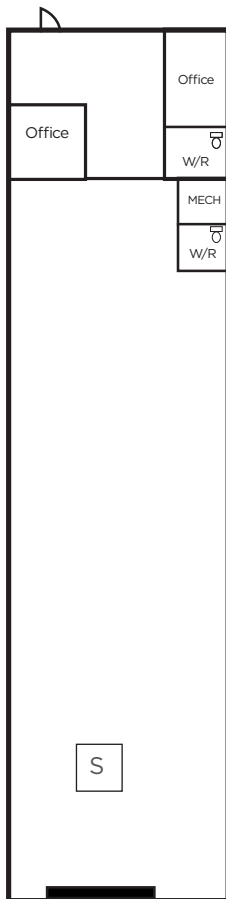

* Sample floor plan for 3,600 SF

SITE PLAN

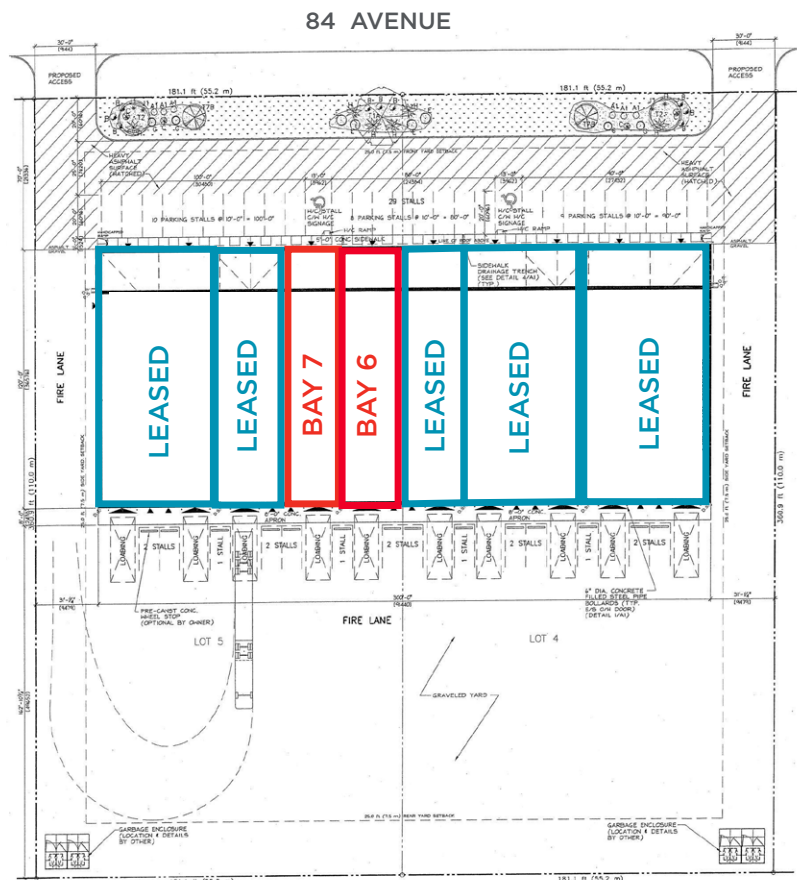



**CUSHMAN &
WAKEFIELD**
Edmonton

Mark Bowman
Associate
780 702 4256
mark.bowman@cwedm.com

Chris Sieben
Partner
780 720 0227
chris.sieben@cwedm.com

Zeshan Qureshi CPA, CA
Partner
780 238 4576
zeshan.qureshi@cwedm.com