

**CUSHMAN &  
WAKEFIELD**  
Edmonton

**FOR LEASE**

# **SOUTHWOOD CENTRE**

9505, 9527 41 Avenue, Ed-  
monton, AB

**8,495 SF AND 11,200 SF AVAILABLE**

## **PROPERTY HIGHLIGHTS**

- 9505: Office/shop end unit with three (3) grade loading doors
- 9527: Office/Shop with (4) dock loading doors
- Fully paved parking lot and marshalling area
- Convenient proximity to 91 Street, 99 Street, 34 Avenue, Whitemud Drive, and Calgary Trail

**Burke Smith**

Partner

780 917 8344

burke.smith@cwedmonton.com

**Nicole Pozer, Unlicensed**

Team Coordinator

780 702 9472

nicole.pozer@cwedmonton.com

**Andy Horvath**

Partner

780 917 8338

andy.horvath@cwedmonton.com

**CUSHMAN & WAKEFIELD  
Edmonton**

Suite 2700, TD Tower

10088 - 102 Avenue

Edmonton, AB T5J 2Z1

[www.cwedmonton.com](http://www.cwedmonton.com)

Cushman & Wakefield Edmonton is independently owned and operated / A Member of the Cushman & Wakefield Alliance. No warranty or representation, express or implied, is made to the accuracy or completeness of the information contained herein, and same is submitted subject to errors, omissions, change of price, rental or other conditions, withdrawal without notice, and to any special listing conditions imposed by the property owner(s). As applicable, we make no representation as to the condition of the property (or properties) in question. August 8, 2023



## PROPERTY DETAILS

Neighbourhood: Strathcona Industrial Park

Ceiling Height:

20' Clear

Zoning:

IB - Industrial Business

### 9505

Available Size: 8,495 SF

Loading Doors: Three (3) Grade (12'x16')

Lease Rate: Market

Additional Rent: \$6.80 per SF (2023)

Availability: November 1, 2023



VIRTUAL TOUR

### 9509

Available Size: 5,495 SF

Loading Doors: Two (2) Grade (12'x16')

Lease Rate: Market

Additional Rent: \$6.80 per SF (2023)

Available: 60 Days Notice



VIRTUAL TOUR

### 9527

Available Size: 11,200 SF

Loading Doors: (4) Dock 9'x10'

Lease Rate: Market

Additional Rent: \$6.80 per SF (2023)

Availability: February 1, 2024

## AERIAL



41 AVENUE





## LOCATION OVERVIEW



## 9505 PROPERTY PHOTOS





## 9505 PROPERTY PHOTOS



## FLOOR PLAN

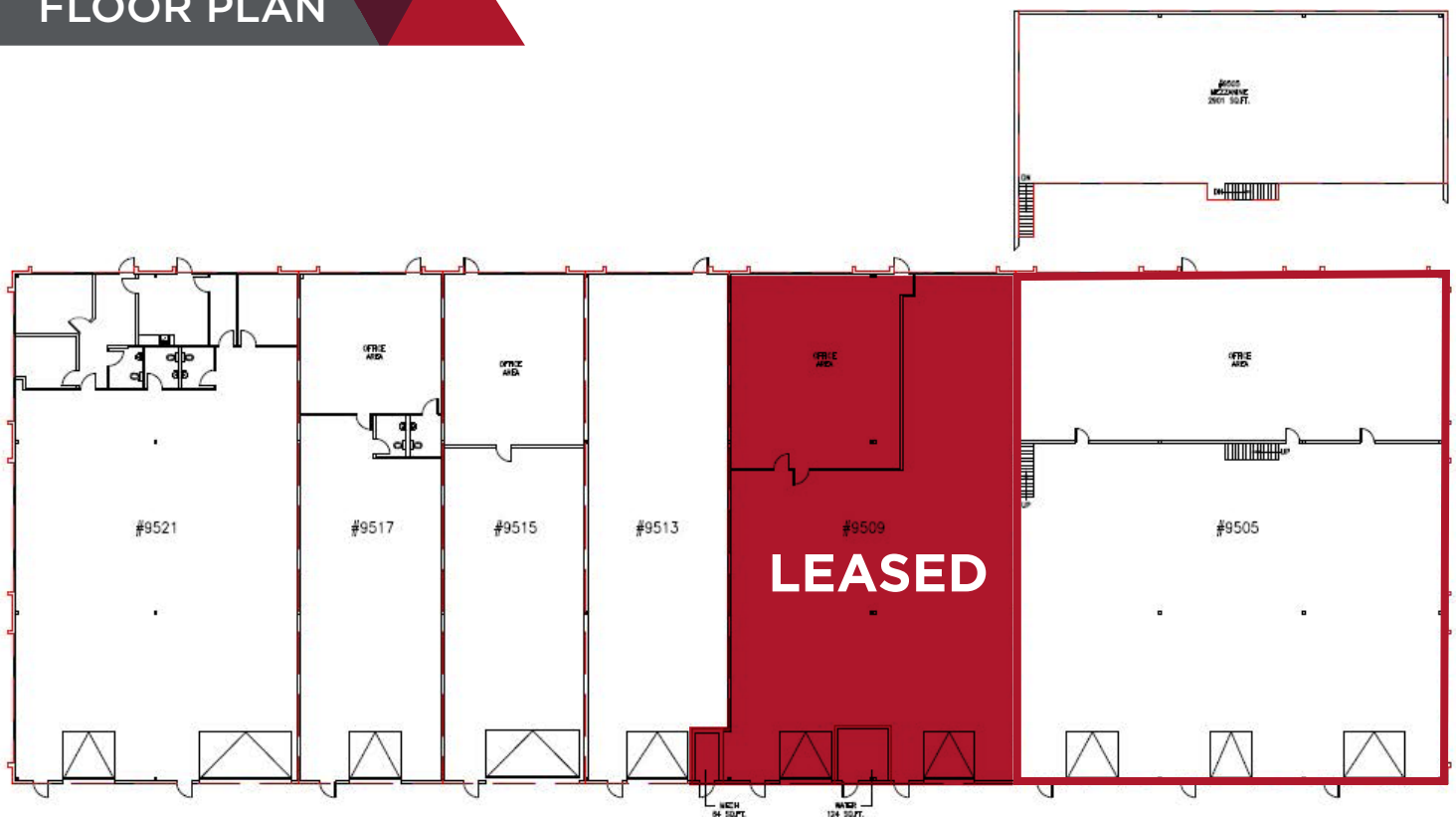

# 9527 FLOOR PLAN

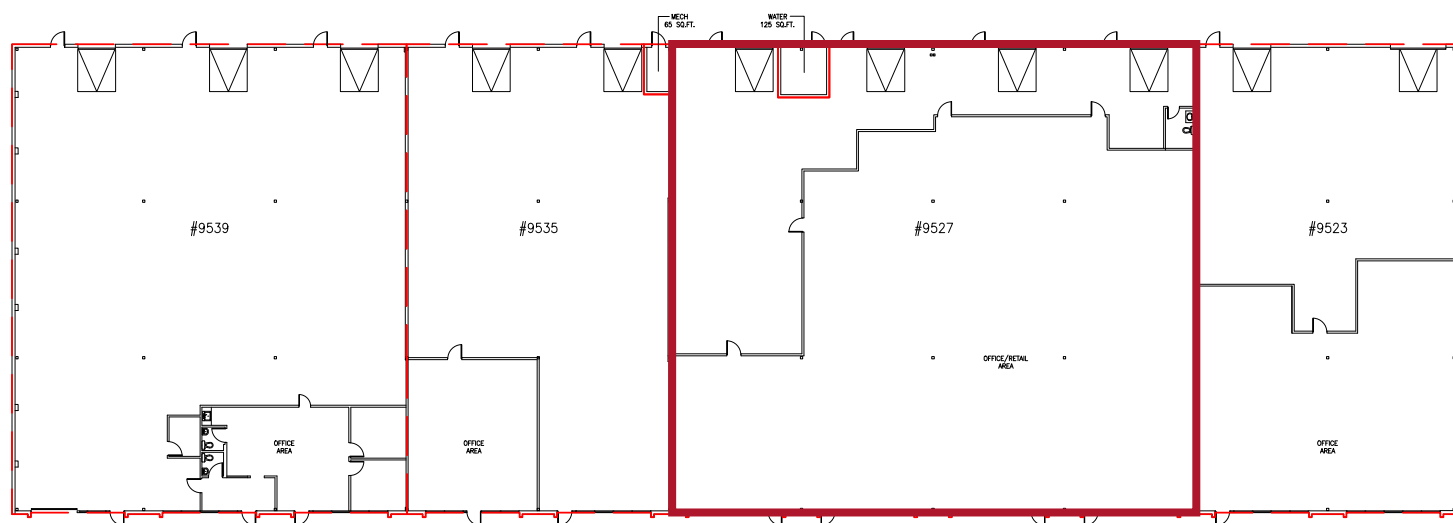

**CUSHMAN &  
WAKEFIELD**  
Edmonton

**Burke Smith**  
Partner  
780 917 8344  
burke.smith@cwedmonton.com

**Nicole Pozer, Unlicensed**  
Team Coordinator  
780 702 9472  
nicole.pozer@cwedmonton.com

**Andy Horvath**  
Partner  
780 917 8338  
andy.horvath@cwedmonton.com