

FOR LEASE

114 AVENUE BUILDING

11319/21 166A Street NW
Edmonton, AB

35,677 SF
Multiple Dock Doors

ONE BAY REMAINING

Burke Smith
Partner
780 917 8344
burke.smith@cwedmonton.com

Andy Horvath
Partner
780 917 8338
andy.horvath@cwedmonton.com

Nicole Pozer
Team Coordinator
780 702 9472
nicole.pozer@cwedmonton.com

Cushman & Wakefield Edmonton is independently owned and operated / A Member of the Cushman & Wakefield Alliance. No warranty or representation, express or implied, is made to the accuracy or completeness of the information contained herein, and same is submitted subject to errors, omissions, change of price, rental or other conditions, withdrawal without notice, and to any special listing conditions imposed by the property owner(s). As applicable, we make no representation as to the condition of the property (or properties) in question. June 1, 2023

PROPERTY HIGHLIGHTS

- Cost competitive option in the Northwest warehouse market
- High dock door count
- Close proximity to 170th Street, 111th Avenue, 118th Avenue, & Yellowhead Trail
- Ready for immediate possession

Building Upgrades

- Roof replacement
- Concrete storage mezzanine for each unit
- 2nd floor windows replacement
- New LED lighting throughout
- New dock seals/bumpers
- New washroom

PROPERTY DETAILS

NEIGHBORHOOD

West Sheffield Industrial

ZONING

IM - Medium Industrial

CEILING HEIGHT

22' Clear

POWER

To be Verified

LEASE RATE

Market

ADDITIONAL RENT 2023

Operating Costs: \$2.08 per SF

Tax: \$2.09 per SF

Plus 4% of Gross Rent Management Fee

AVAILABILITY

Immediately

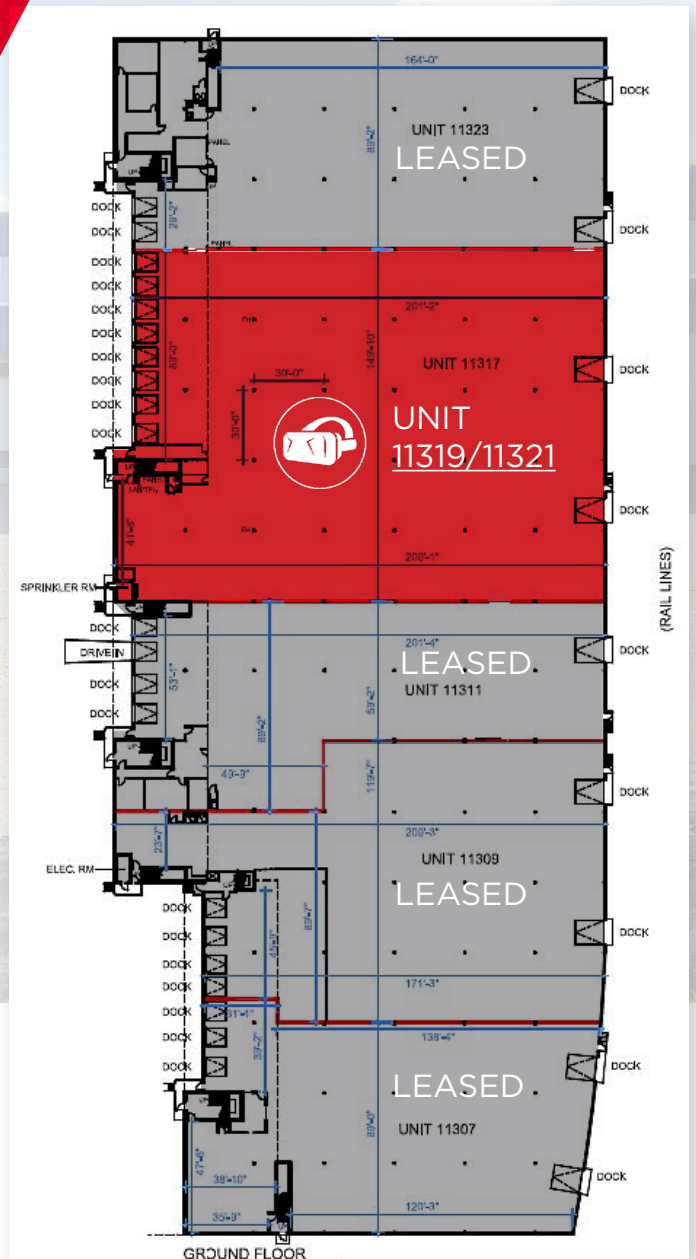

Unit	Available size & loading			Loading Doors
	Main Floor	Mezzanine	Total	
Unit 11319/21	30,721 SF	4,956 SF	35,677 SF	(8) Dock



Click to view virtual tour

Unit 11319

PROPERTY PHOTOS



LOCATION OVERVIEW



Burke Smith
Partner
780 917 8344
burke.smith@cwedm.com

Andy Horvath
Partner
780 917 8338
andy.horvath@cwedm.com

Nicole Pozer
Team Coordinator
780 702 9472
nicole.pozer@cwedm.com

Cushman & Wakefield Edmonton is independently owned and operated / A Member of the Cushman & Wakefield Alliance. No warranty or representation, express or implied, is made to the accuracy or completeness of the information contained herein, and same is submitted subject to errors, omissions, change of price, rental or other conditions, withdrawal without notice, and to any special listing conditions imposed by the property owner(s). As applicable, we make no representation as to the condition of the property (or properties) in question. June 1, 2023