

FOR SALE

SHERWOOD INDUSTRIAL ESTATES BUILDING

**9,778 SF on 1.23 Acres
Two Tenant Industrial Property
With Potential Income**

2107 87 Avenue, Edmonton, AB

Cushman & Wakefield Edmonton

Suite 2700, TD Tower
10088 102 Avenue
Edmonton, AB T5J 2Z1
cwedm.com

Chris Sieben

Partner
780 720 0227
chris.sieben@cwedm.com

Kennedy Munro

Associate
780 670 3042
kennedy.munro@cwedm.com

PROPERTY HIGHLIGHTS

- Grade loading with fenced yard
 - In-floor radiant heat
 - Located in Sherwood Industrial Estates
- Excellent access to Sherwood Park Freeway, 17 Street, and 34 Avenue
- Property is located in Strathcona County with the benefit of lower property taxes
- Unit A leased until August 31, 2023, potential to extend
- Unit B to be vacant upon sale
- Easily converted to single user property

17 STREET

SHERWOOD PARK FREEWAY

ANTHONY HENDAY DRIVE



PROPERTY DETAILS

MUNICIPAL ADDRESS

2107 87 Avenue, Edmonton, AB
(County of Strathcona)

LEGAL DESCRIPTION

Plan 4452TR, Block 2, Lot 12

ZONING

IM (Medium Industrial)

AVAILABILITY

Unit A: 4,113 SF

Unit B: 5,665 SF

Total: 9,778 SF

SITE SIZE

1.23 Acres

CEILING HEIGHT

16' Clear in Warehouse

POWER

600 Volt Main, 225 KVA
Transformer on Site (TBC)

HEATING

In-Floor Radiant in
Warehouse

Rooftop HVAC
in Office

SALE PRICE

\$2,575,000

TAXES

\$23,962 (2022)

FLOOR PLAN

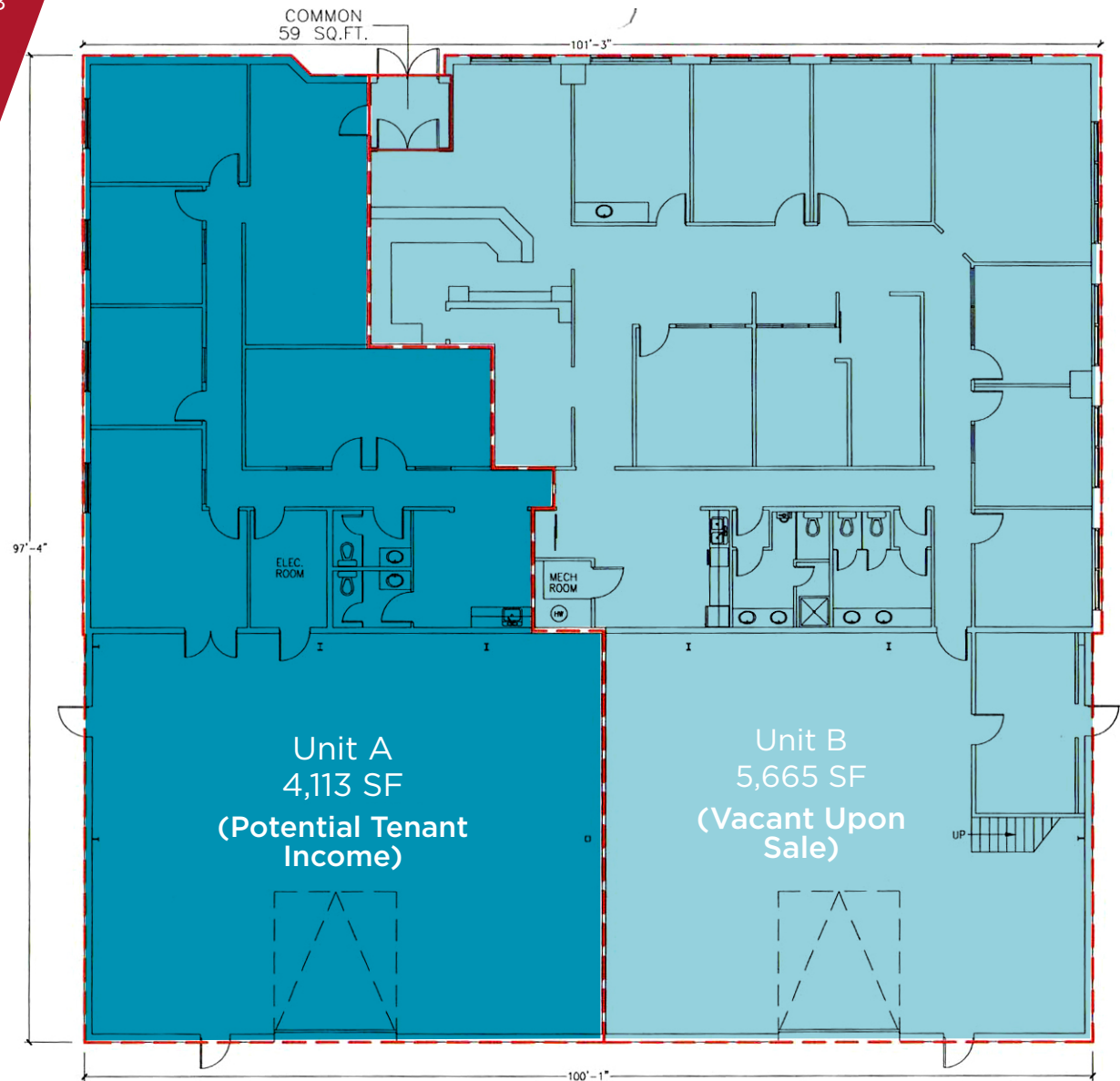



Chris Sieben
Partner
780 720 0227
chris.sieben@cwedmonton.com

Kennedy Munro
Associate
780 670 3042
kennedy.munro@cwedmonton.com

Cushman & Wakefield Edmonton is independently owned and operated / A Member of the Cushman & Wakefield Alliance. No warranty or representation express or implied is made to the accuracy or completeness of the information contained herein, and same is submitted subject to errors, omissions, change of price, rental or other conditions, withdrawal without notice, and to any special listing conditions imposed by the property owner(s). As applicable, we make no representation as to the condition of the property for properties in question. December 9, 2022