



High Exposure Retail Bays and Office Space

Property Highlights

- Excellent exposure to 137th Avenue with 28,300 VPD
- Excellent exposure to 97th Street with 46,500 VPD
- Close proximity to the Northgate Transit Centre



Dustin Bateyko
Associate Partner
780 702 4257
dustin.bateyko@cwedm.com

CUSHMAN & WAKEFIELD
Edmonton
Suite 2700, TD Tower
10088 - 102 Avenue
Edmonton, AB T5J 2Z1
www.cwedm.com



Property Details

AVAILABILITY:	2,300 SF - 2nd floor office space
BASIC RENT:	Negotiable
ADDITIONAL RENT:	\$10.00 per SF (Est. 2019)
SITE SIZE:	33,058 SF
ZONING:	CSC - Shopping Centre Zone
CORRIDOR:	97 th Street
AVAILABLE:	Immediately
PARKING:	Ample surface parking



Dustin Bateyko
Associate Partner
780 702 4257
dustin.bateyko@cwedm.com

CUSHMAN & WAKEFIELD
Edmonton
Suite 2700, TD Tower
10088 - 102 Avenue
Edmonton, AB T5J 2Z1
www.cwedm.com

Main Floor Plan

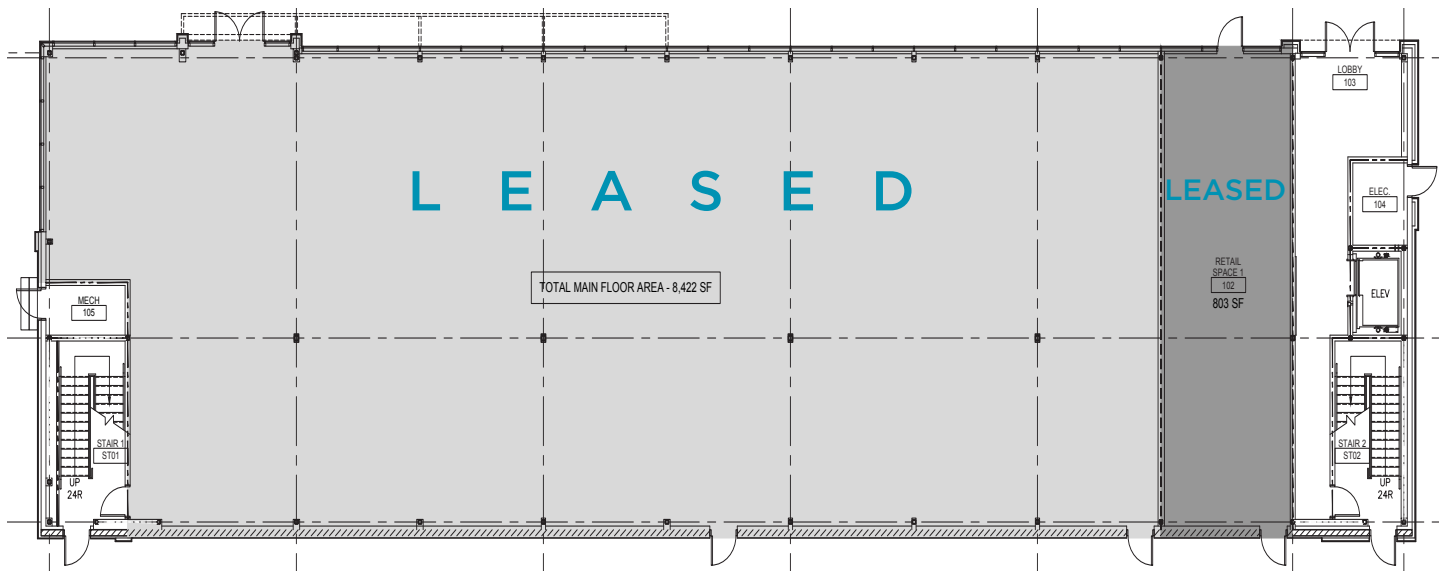

Second Floor Plan

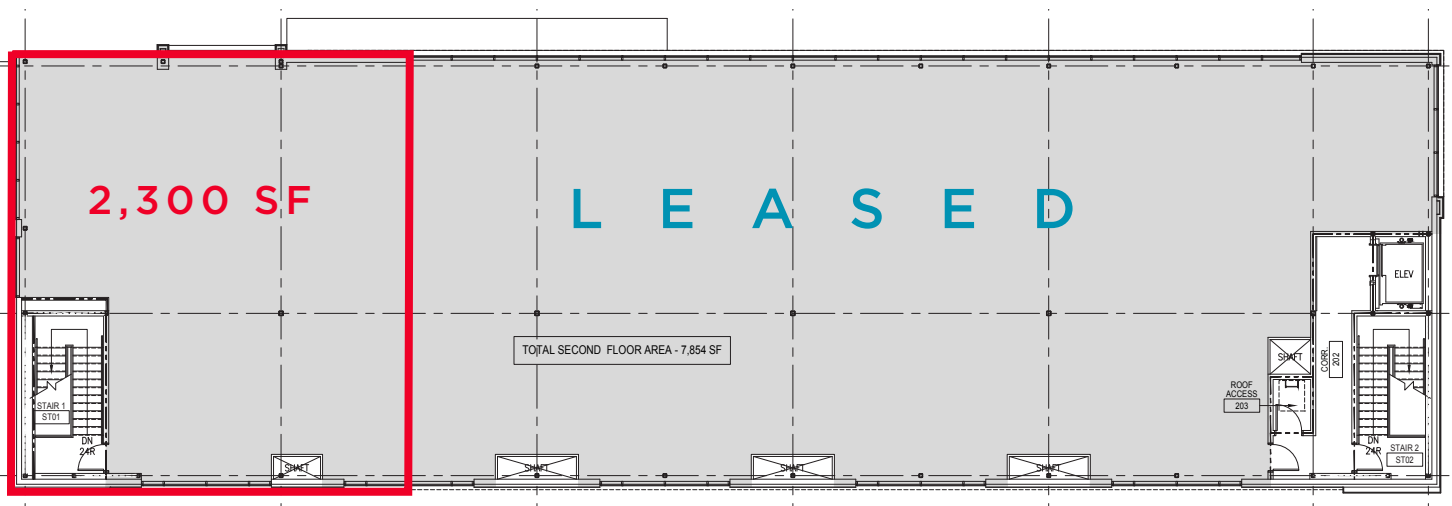

Dustin Bateyko
Associate Partner
780 702 4257
dustin.bateyko@cwedmonton.com

CUSHMAN & WAKEFIELD
Edmonton
Suite 2700, TD Tower
10088 - 102 Avenue
Edmonton, AB T5J 2Z1
www.cwedmonton.com



**CUSHMAN &
WAKEFIELD**
Edmonton

FOR LEASE

Professional Building on 97th Street
12970 97 Street, Edmonton, AB

DEMOGRAPHICS

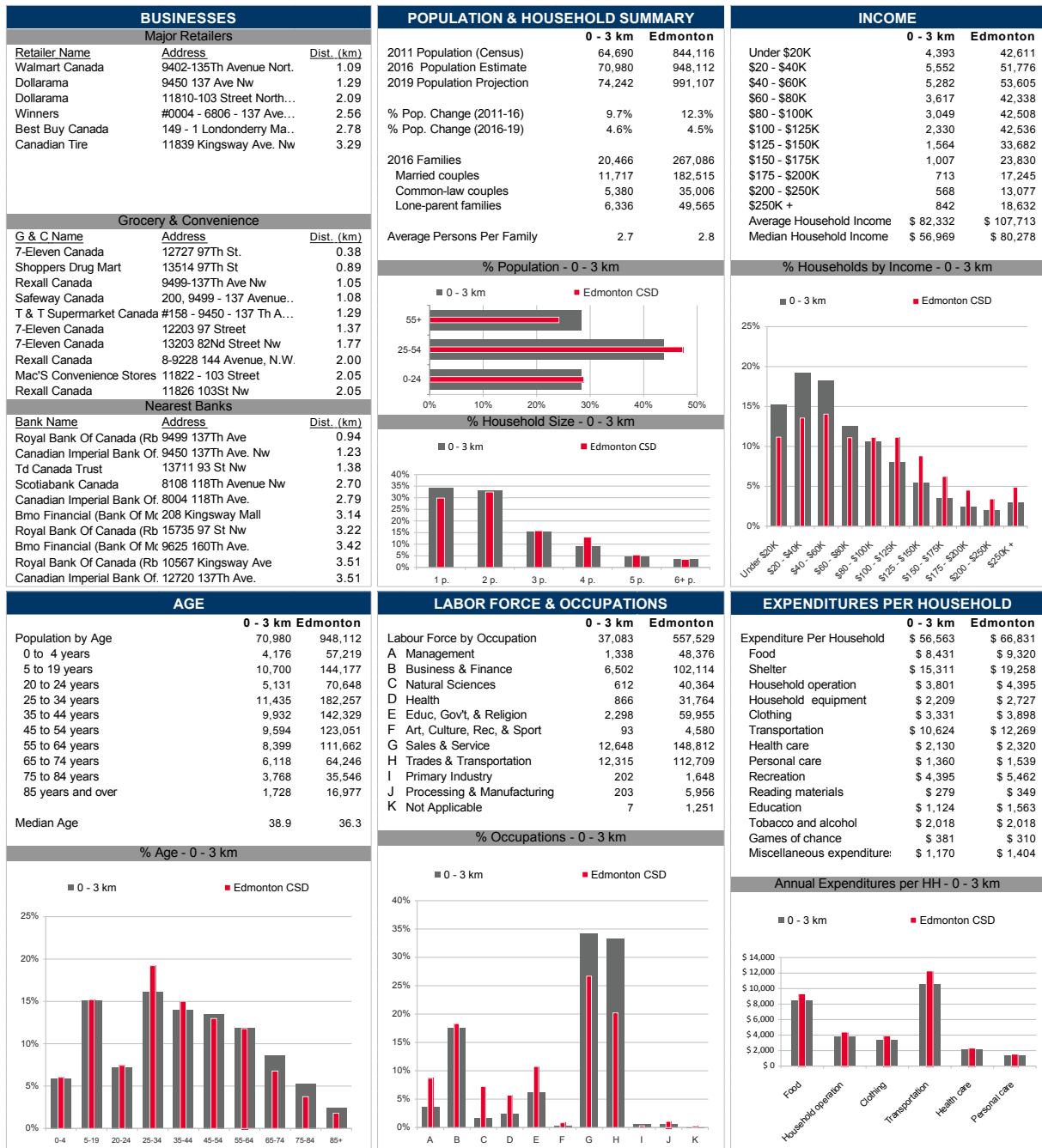

Dustin Bateyko
Associate Partner
780 702 4257
dustin.bateyko@cwedm.com

CUSHMAN & WAKEFIELD
Edmonton
Suite 2700, TD Tower
10088 - 102 Avenue
Edmonton, AB T5J 2Z1
www.cwedm.com

Cushman & Wakefield Edmonton is independently owned and operated / A Member of the Cushman & Wakefield Alliance. No warranty or representation, express or implied, is made to the accuracy or completeness of the information contained herein, and same is submitted subject to errors, omissions, change of price, rental or other conditions, withdrawal without notice, and to any special listing conditions imposed by the property owner(s). As applicable, we make no representation as to the condition of the property (or properties) in question. August 5, 2021