

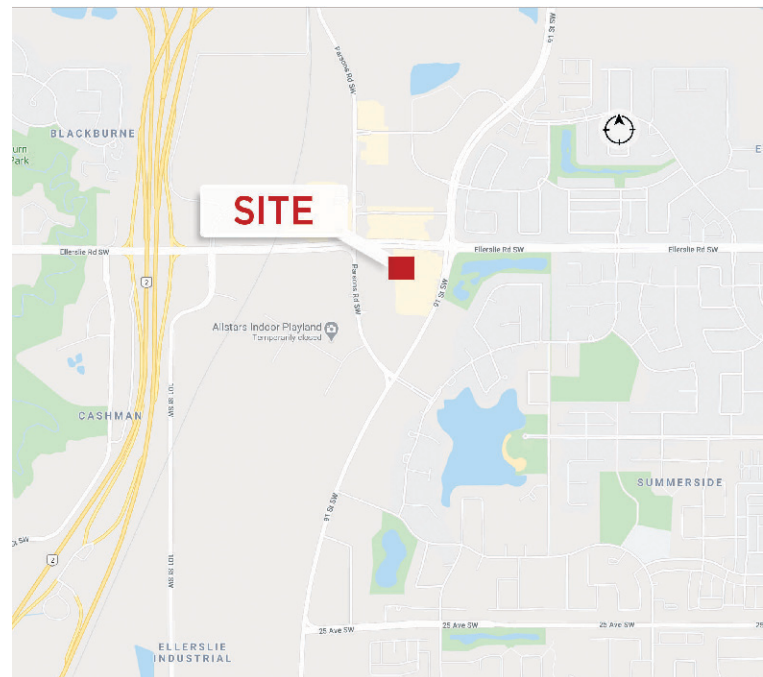

1,087 SF Available

Property Highlights

- Join: Save-On Foods, Shoppers Drug Mart, Bank Of Montreal, Scotiabank, Panago Pizza, Bone & Biscuit, Nova Cannabis and other quality retailers
- Other retailers in the area include: Dollarama, McDonald's, TD Bank, ATB, The Canadian Brewhouse, Original Joe's, Starbucks, KFC and more
- Hotels in the immediate area are: Holiday Inn, Best Western Plus, Hampton Inn by Hilton, Sandman Signature, Four Points Sheraton and they provide approximately 750 rooms.
- This centre is in close proximity to numerous high grade industrial and office buildings.
- Average Daily Traffic on Ellerslie Road & 91 Street is 25,900 vehicles per day.
- Population (3KM) 48,079 (est. 2020)
- Average Household Income (3KM) \$132,056
- Operating Costs: \$17.06 per SF, excluding management fees (2023)



Gary Killips
Partner
780 917 8332
gary.killips@cwedm.com

Mark McCann
Partner
780 917 8328
mark.mccann@cwedm.com

CUSHMAN & WAKEFIELD
Edmonton
Suite 2700, TD Tower
10088 - 102 Avenue
Edmonton, AB T5J 2Z1
www.cwedm.com



**CUSHMAN &
WAKEFIELD**
Edmonton

FOR LEASE

Market at Summerside

Ellerslie Road & 91 Street, Edmonton, AB

Demographics

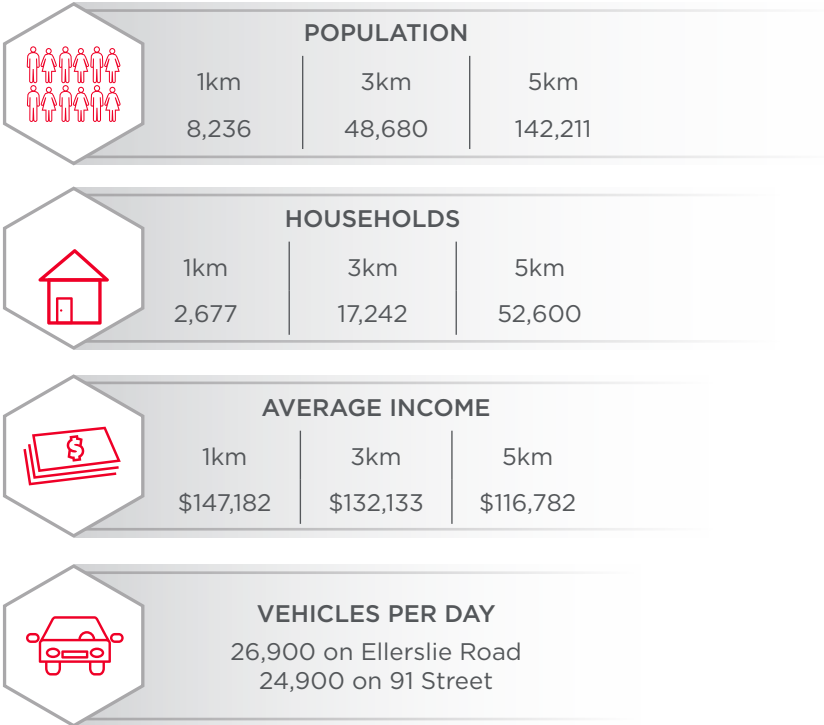

Floor Plan

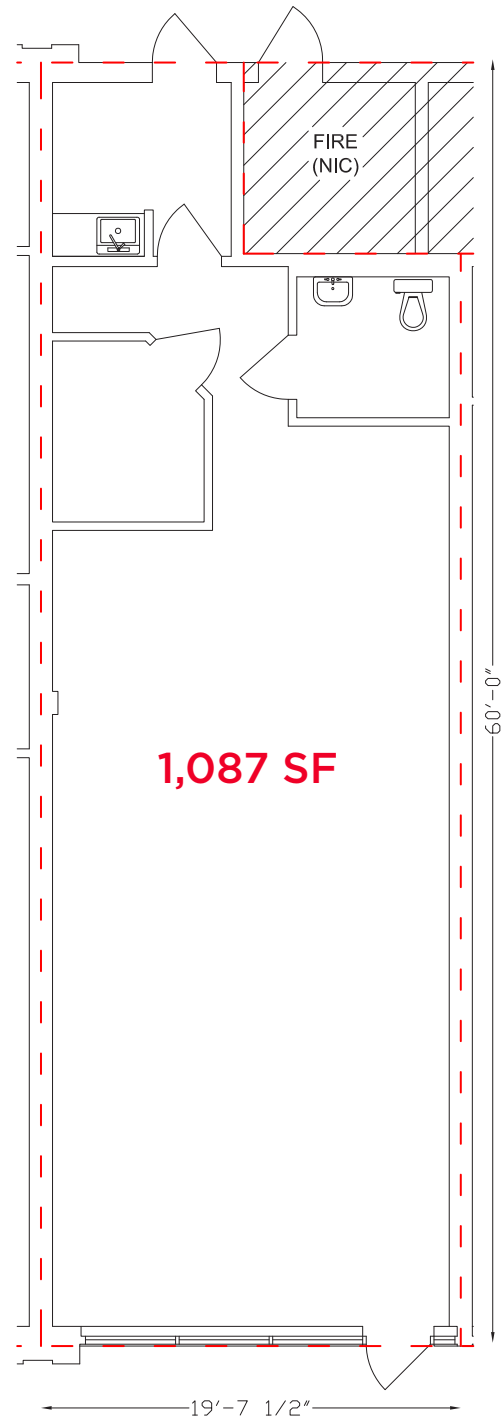

Gary Killips
Partner
780 917 8332
gary.killips@cwedm.com

Mark McCann
Partner
780 917 8328
mark.mccann@cwedm.com

**CUSHMAN & WAKEFIELD
Edmonton**
Suite 2700, TD Tower
10088 - 102 Avenue
Edmonton, AB T5J 2Z1
www.cwedm.com

Cushman & Wakefield Edmonton is independently owned and operated / A Member of the Cushman & Wakefield Alliance. No warranty or representation, express or implied, is made to the accuracy or completeness of the information contained herein, and same is submitted subject to errors, omissions, change of price, rental or other conditions, withdrawal without notice, and to any special listing conditions imposed by the property owner(s). As applicable, we make no representation as to the condition of the property (or properties) in question. Oct. 22, 2022

Site Plan

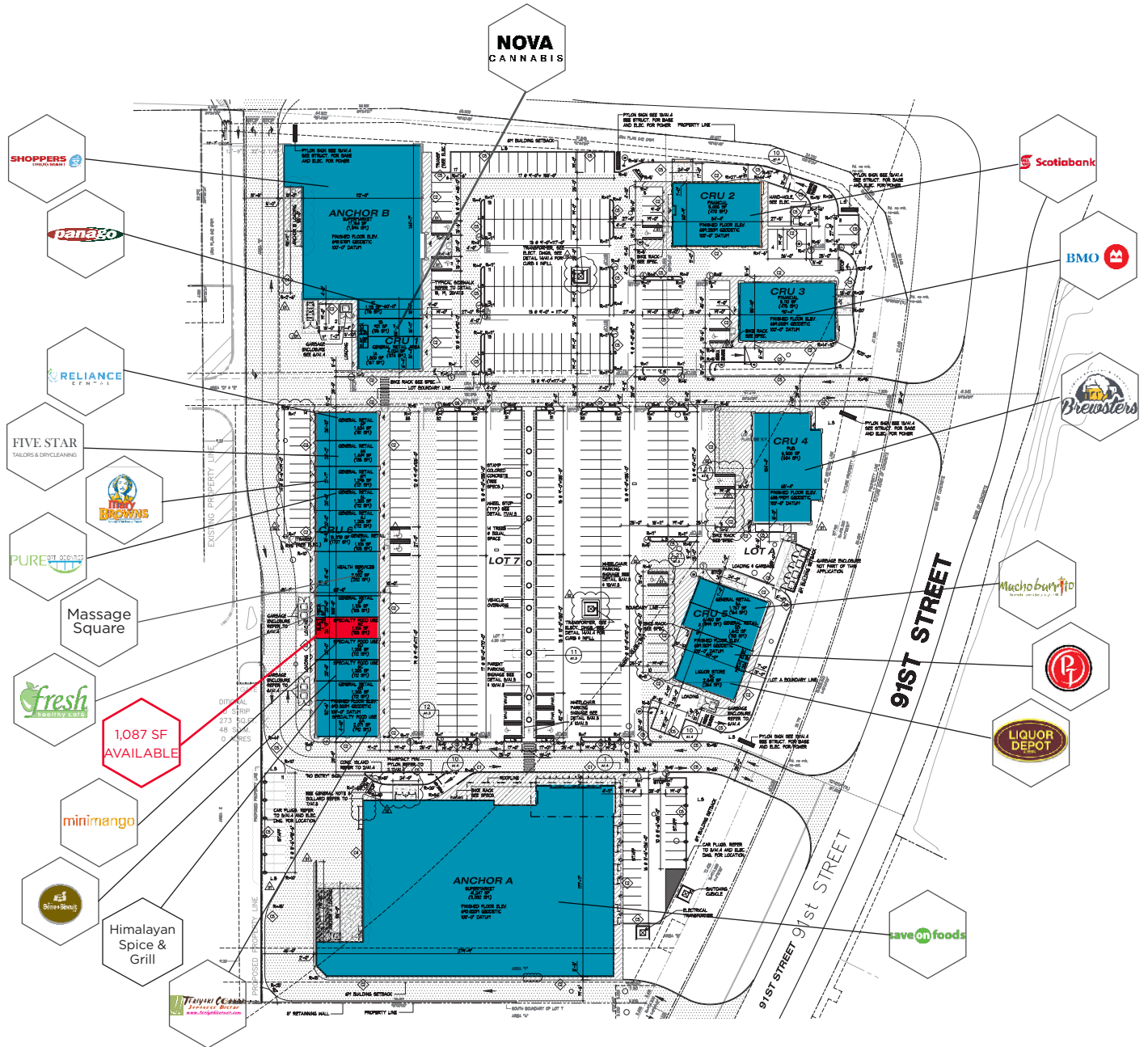

Gary Killips
Partner
780 917 8332
gary.killips@cwedm.com

Mark McCann
Partner
780 917 8328
mark.mccann@cwedm.com

CUSHMAN & WAKEFIELD
Edmonton
Suite 2700, TD Tower
10088 - 102 Avenue
Edmonton, AB T5J 2Z1
www.cwedm.com