

YOUR  
SIGNAGE  
HERE

Village Landing  
**DAYCARE**

FOR LEASE

# FORMER THEATRE AT VILLAGE LANDING

140 ST. ALBERT TRAIL, ST. ALBERT, AB

Up to 19,000 SF Available  
Located on the lower level

Cushman & Wakefield Edmonton  
Suite 2700, TD Tower  
10088 102 Avenue  
Edmonton, AB T5J 2Z1  
cwedm.com

**Gary Killips**  
Partner  
780 917 8332  
gary.killips@cwedm.com

**Mark McCann**  
Partner  
780 917 8328  
mark.mccann@cwedm.com



# OVERVIEW

Save on Foods grocery anchored site located on the North West corner of St. Albert Trail & Gervais Road

St. Albert Trail sees over 37,000 vehicles per day

Tenants include: Shoppers Drug Mart, Dollarama, Starbucks, Wendy's, Ricky's, Pet Value, Anytime Fitness, Swiss Chalet and many more!

CC - Corridor Commercial District Zoning allows for a wide variety of Retail uses

Rental Rate: Market

ANTHONY HENDAY DRIVE

ST. ALBERT TRAIL

HEBERT ROAD



UP TO 19,000 SF  
(SUB-DIVISIBLE)



**SITE**  
(ENTRANCE AT BACK OF BUILDING)



# PROPERTY DETAILS

## MUNICIPAL ADDRESS

140 St. Albert Trail, St. Albert, AB

## LEGAL DESCRIPTION

Plan 042683, Block 3, Lot 14

## ZONING

CC - Corridor Commercial District

## NEIGHBOURHOOD

Grandin





# SITE PLANS

## MEZZANINE PLAN

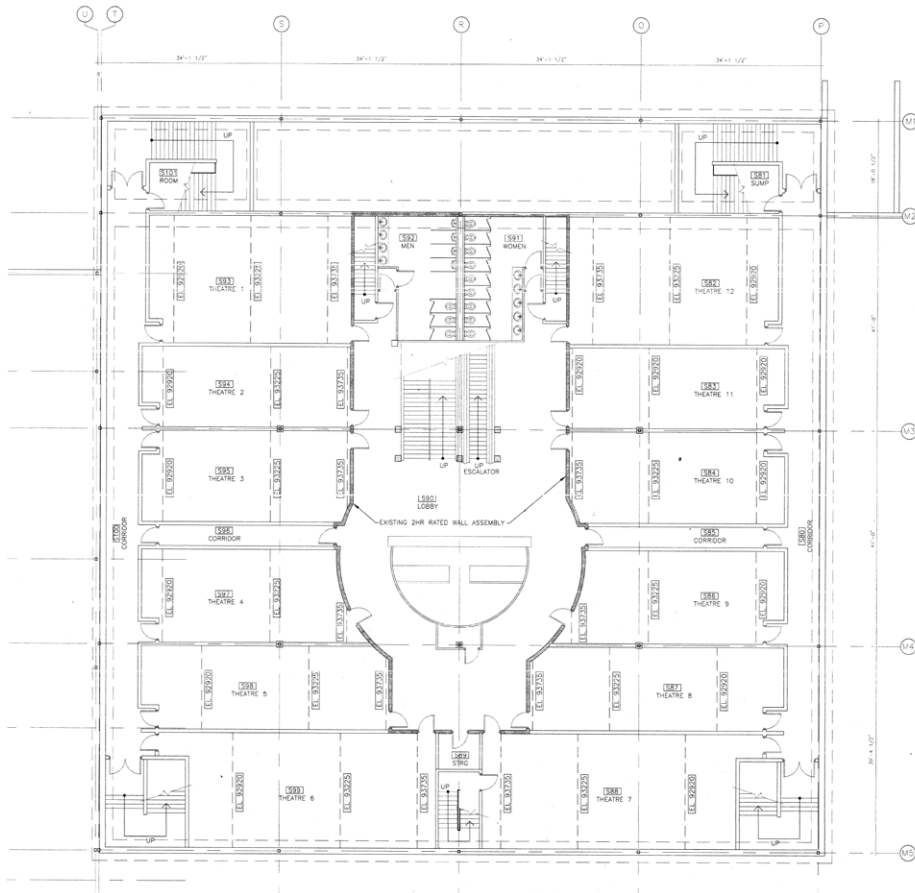

## BASEMENT PLAN

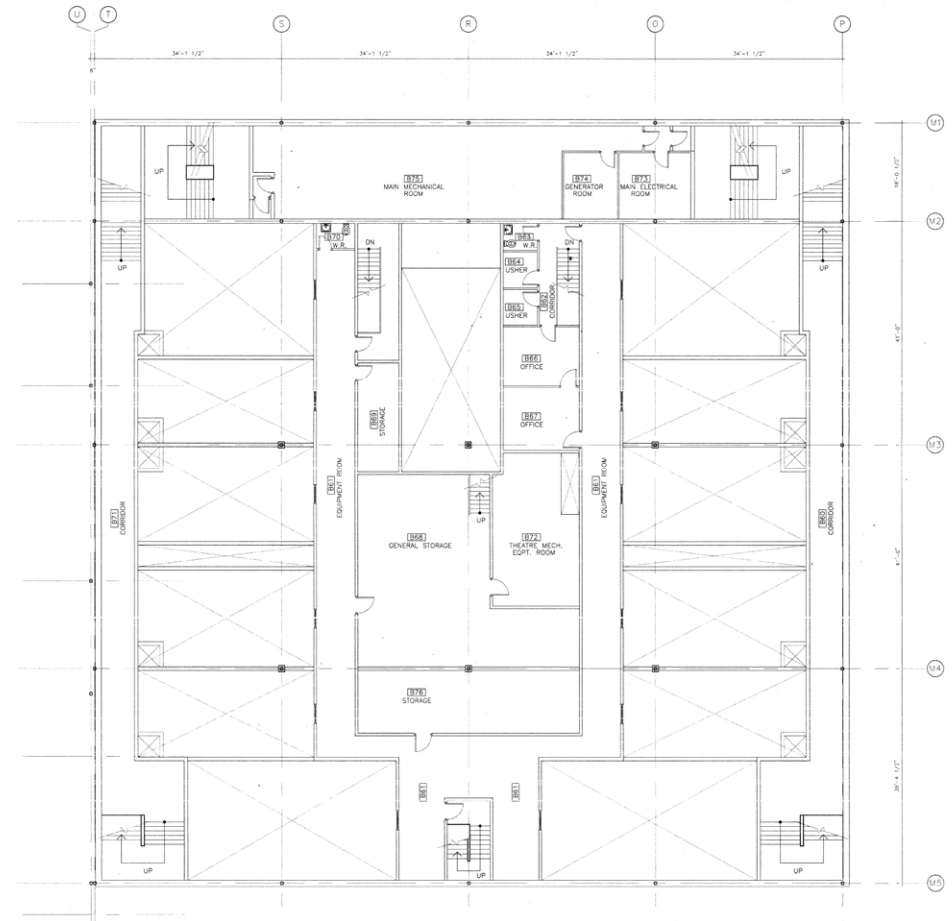

**CUSHMAN &  
WAKEFIELD**  
Edmonton

**Gary Killips**  
Partner  
780 917 8332  
gary.killips@cwedm.com

**Mark McCann**  
Partner  
780 917 8328  
mark.mccann@cwedm.com