

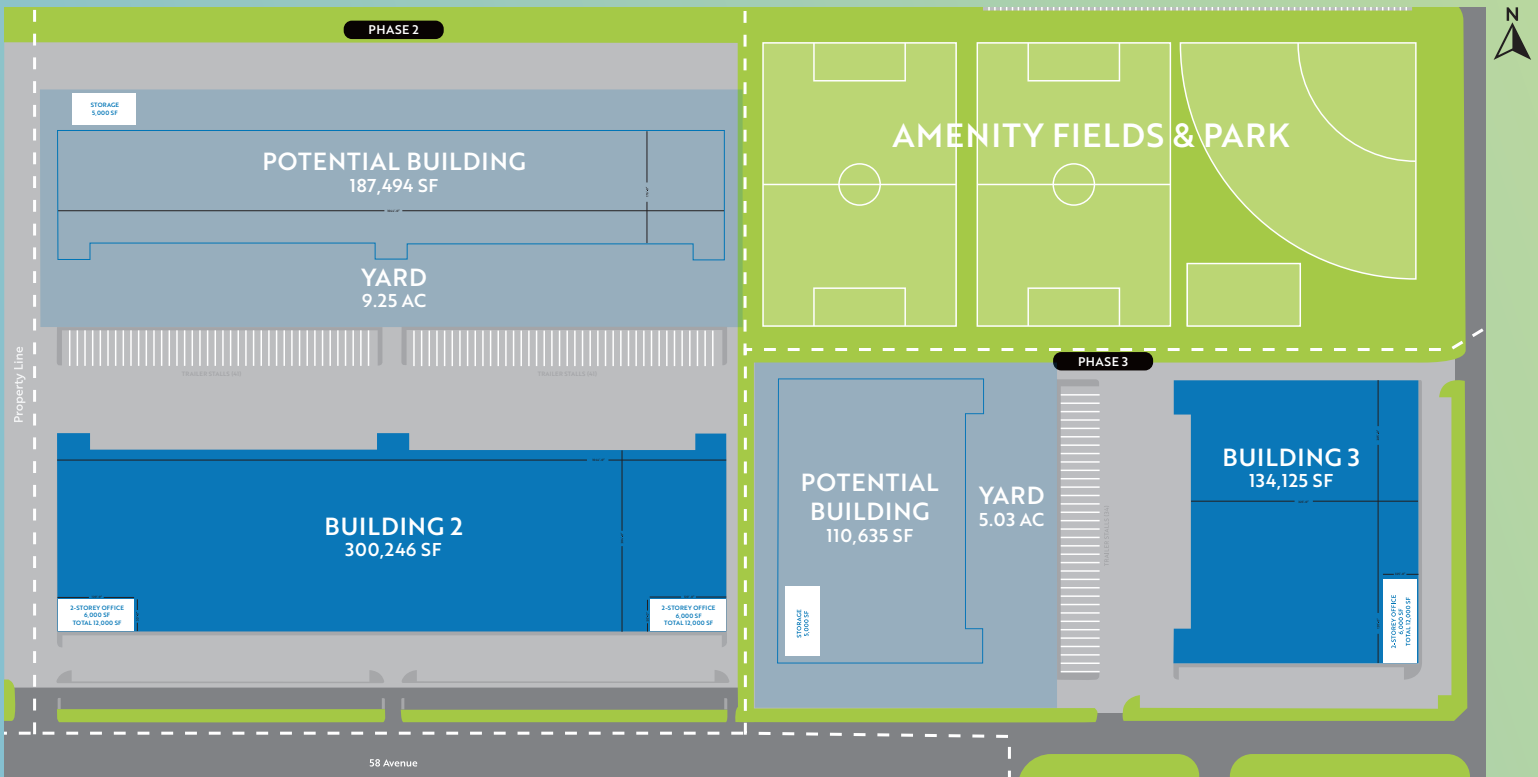

PHASE 2 & 3 - OPTION 1

This potential build-to-suit layout can accommodate up to 300,246 SF and allows for a flexible yard configuration of up to 9.25 acres, or a second facility of up to 187,494 SF. The smaller building design within Phase 3 can accommodate up to 134,125 SF and allows for flexible yard configurations of up to 5.03 acres, or for a second facility of up to 110,635 SF. With Beedie's industry-leading build-to-suit program, you can choose from a wide range of customizable options to fit your exact specifications.



BURKE SMITH
Partner
780.917.8344
burke.smith@cwedm.com

ANDY HORVATH
Partner
780.917.8338
andy.horvath@cwedm.com

NICOLE POZER
Team Coordinator
780.702.9472
nicole.pozer@cwedm.com

Marketed by
CUSHMAN & WAKEFIELD
Edmonton



PHASE 2 & 3 - OPTION 2

To maximize the acreage within Phase 2, an alternative build-to-suit layout can accommodate up to 562,128 SF (with the ability to demise into two tenancies) and allows for larger industrial users to find flexible configurations with storage yard or trailer parking in a prime location that offers easy access to transportation networks and key markets. By designing a facility that is tailored to suit your needs, you can maximize efficiency and productivity while gaining a competitive advantage in your industry.

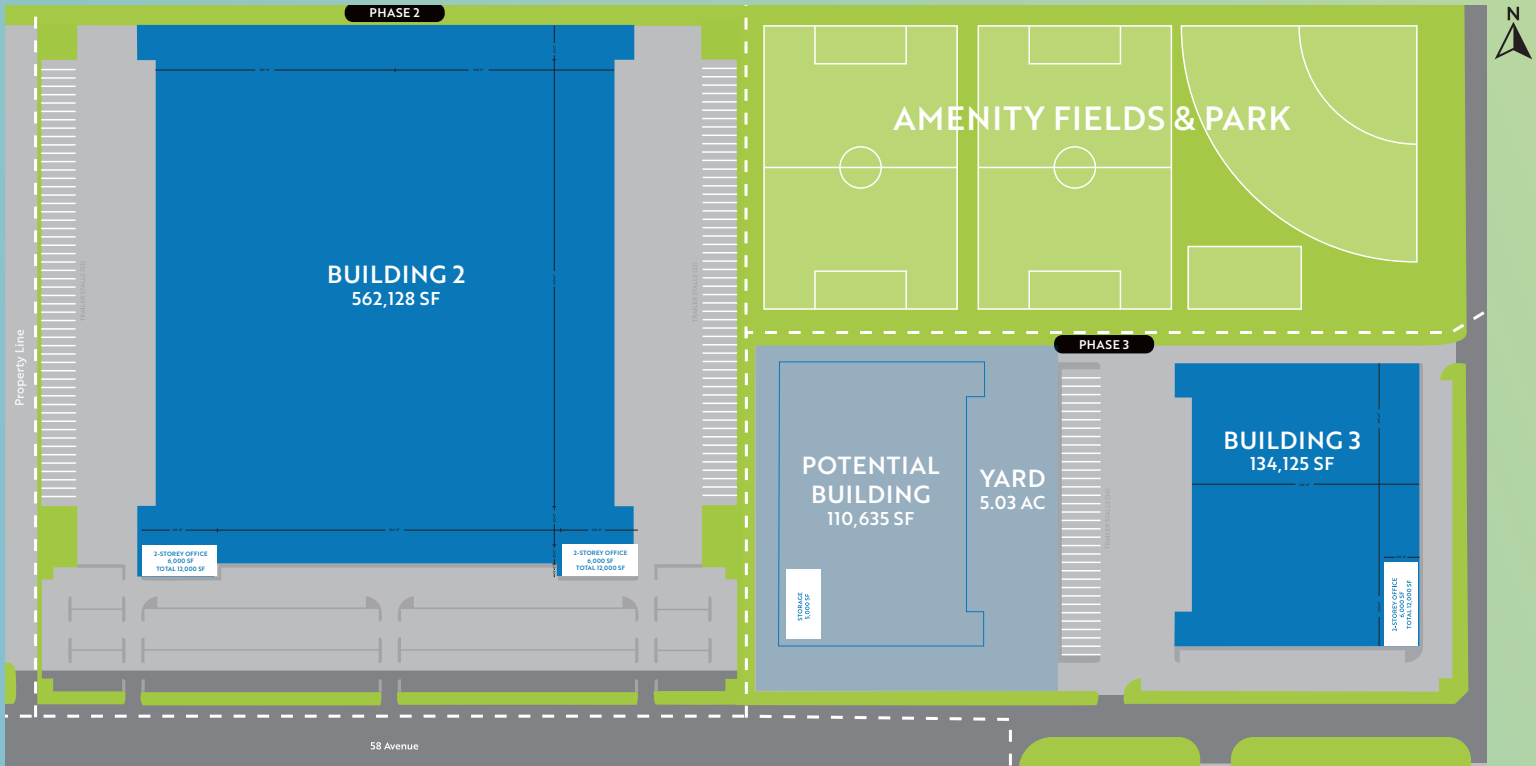

BURKE SMITH

Partner
780.917.8344
burke.smith@cwedm.com

ANDY HORVATH

Partner
780.917.8338
andy.horvath@cwedm.com

NICOLE POZER

Team Coordinator
780.702.9472
nicole.pozer@cwedm.com

