

FUNCTIONAL SHOP WITH YARD

IM (MEDIUM INDUSTRIAL) ZONING

 **CUSHMAN &  
WAKEFIELD**  
Edmonton

**FOR SALE**

**112 AVENUE  
WEST END  
MANUFACTURING  
FACILITY**

15816 112 Avenue NW,  
Edmonton, AB

**FORMER IRON  
FURNITURE  
MANUFACTURING**

**Seif Jiwaji**  
Senior Associate  
780 643 2141  
[seif.jiwaji@cwedm.com](mailto:seif.jiwaji@cwedm.com)

Cushman & Wakefield Edmonton is independently owned and operated / A Member of the Cushman & Wakefield Alliance. No warranty or representation express or implied is made to the accuracy or completeness of the information contained herein, and same is submitted subject to errors, omissions, change of price, rental or other conditions, withdrawal without notice, and to any special listing conditions imposed by the property owner(s). As applicable, we make no representation as to the condition of the property for properties in question. April 5, 2023

# THE OPPORTUNITY

114 AVENUE NW

**SITE**

112 AVENUE NW

111 AVENUE NW

163 STREET NW

- Three buildings
- Main bldg is 11,455 SF (includes partially finished retail)
- +/- 2,750 SF second floor office (partially finished)
- +/- 3,000 SF welding shop, steel frame construction
- +/- 3,600 SF carpenter shop, steel frame construction
- Grade loading OH doors (10.5')
- Yard space leased on a gross basis

# PROPERTY DETAILS

<b>Municipal Address:</b>	15816 112 Avenue NW, Edmonton, AB
<b>Legal Description:</b>	Plan 987KS, Block 5, Lot 6
<b>Zoning:</b>	IM - Medium Industrial
<b>Year Built:</b>	1977
<b>Site Size:</b>	1.52 Acres
<b>Site Coverage:</b>	26%
<b>Leasable Area:</b>	+/- 18,079 SF
<b>Power:</b>	480 volt, 600 amp, 3 phase - TBC by Purchaser
<b>Heating:</b>	Forced air furnace, and unit heaters
<b>Clear Height:</b>	Varies from 11' - 17.5'
<b>Yard Details:</b>	- Paved front parking area. - Gravelled & fenced yard.
<b>Utilities:</b>	Municipal Services at property line (gas, power and water)
<b>Current Income:</b>	\$6000/month (gross)
<b>Operating Cost:</b>	TBC
<b>Sale Price:</b>	\$2,200,000
<b>Taxes:</b>	\$36,275 (2022)
<b>Availability:</b>	Immediately
<b>City Assessment:</b>	\$1,500,000 (2022)



# YARD PHOTOS

# FIRST FLOOR



# SECOND FLOOR UNFINISHED



# SITE PLAN

NORTH

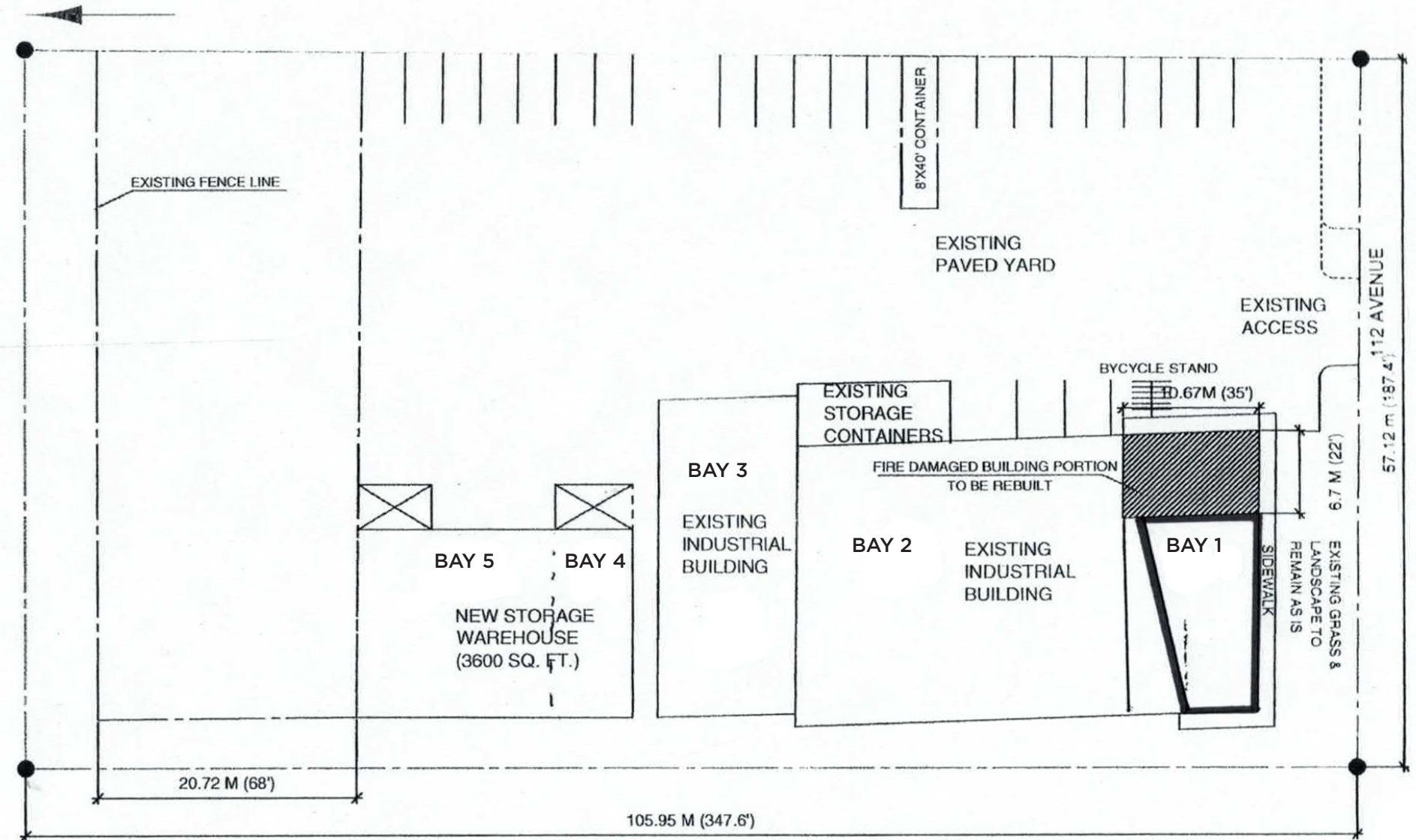



**Seif Jiwaji**  
Senior Associate

780 643 2141  
[seif.jiwaji@cwedm.com](mailto:seif.jiwaji@cwedm.com)