

**CUSHMAN & WAKEFIELD**  
Edmonton

**Starlight** INVESTMENTS

# BONAVENTURE GATE, 13140 ST. ALBERT TRAIL EDMONTON

**FOR LEASE  
7,277 SF AVAILABLE**

Cushman & Wakefield Edmonton  
Suite 2700, TD Tower  
10088 102 Avenue  
Edmonton, AB T5J 2Z1  
[cwedm.com](http://cwedm.com)

Cushman & Wakefield Edmonton is independently owned and operated / A Member of the Cushman & Wakefield Alliance. No warranty or representation express or implied is made to the accuracy or completeness of the information contained herein, and same is submitted subject to errors, omissions, change of price, rental or other conditions, withdrawal without notice, and to any special listing conditions imposed by the property owner(s). As applicable, we make no representation as to the condition of the property for properties in question. September 19, 2023

**Nick Mytopher**  
Associate  
587 597 5475  
[nick.mytopher@cwedm.com](mailto:nick.mytopher@cwedm.com)

**Will Harvie**  
Associate Partner  
780 902 4278  
[will.harvie@cwedm.com](mailto:will.harvie@cwedm.com)

**Kurt Paull, SIOR**  
Associate Partner  
780 702 4258  
[kurt.paull@cwedm.com](mailto:kurt.paull@cwedm.com)

**Max McPeak**  
Associate  
780 700 5038  
[max.mcpeak@cwedm.com](mailto:max.mcpeak@cwedm.com)

**ABUNDANT ON-SITE PARKING  
TURN-KEY PACKAGES AVAILABLE**

ST ALBERT TRAIL



# THE OPPORTUNITY

- Convenient access to St. Albert Trail, Yellowhead & Anthony Henday Drive
- Ample surface parking with additional street parking available
- Prominent building and pylon signage opportunities with exposure to St. Albert trail
- Above market inducements including turnkey options or tenant allowance
- Fibre Optic available through Bell
- Variety of nearby amenities including restaurants, cafes and retail
- Professionally managed

Concept 1

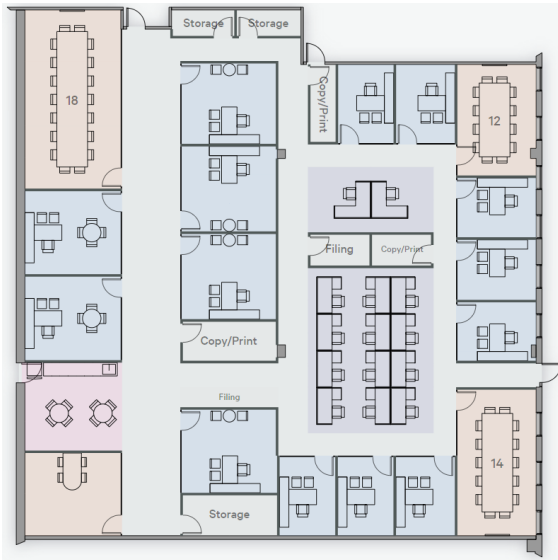

3D Plan



Concept 2

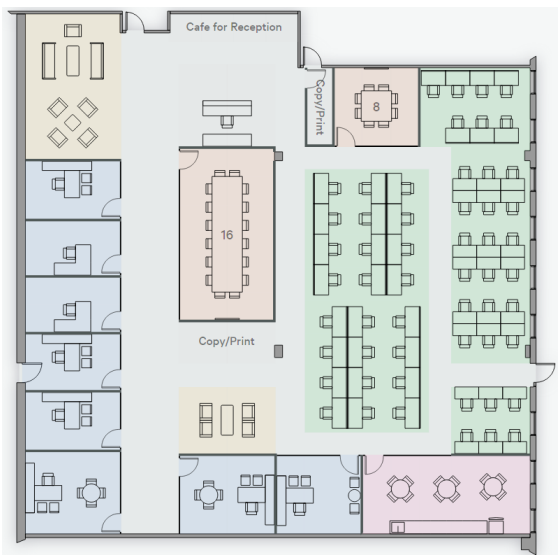

3D Plan

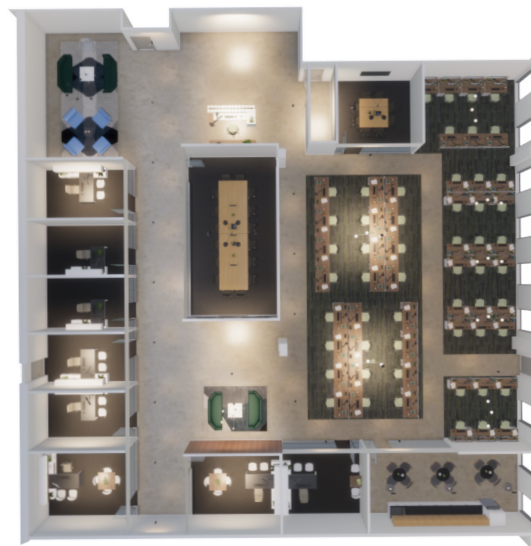

# PROPERTY DETAILS

**AVAILABLE AREA**  
7,277 SF

**BASE RENT**  
Starting at \$10.00 Per SF

**OPERATING COSTS**  
\$11.25 Per SF

**TI ALLOWANCE**  
Negotiable

**AVAILABILITY**  
Immediately

**ZONING**  
IB (Industrial Business)

**PARKING**  
4 stalls per 1,000 SF  
plus additional street parking

## PERMITTED USES

- Business Support Services
- Breweries, Wineries and Distilleries
- Cannabis Retail Sales
- Creation and Production Establishments
- Equipment Rentals, provided that all equipment and goods for rent are contained within an enclosed building
- Gas Bars
- General Industrial Uses
- Liquor Stores
- Major Service Stations
- Minor Service Stations
- Professional, Financial and Office Support Services
- Special Event

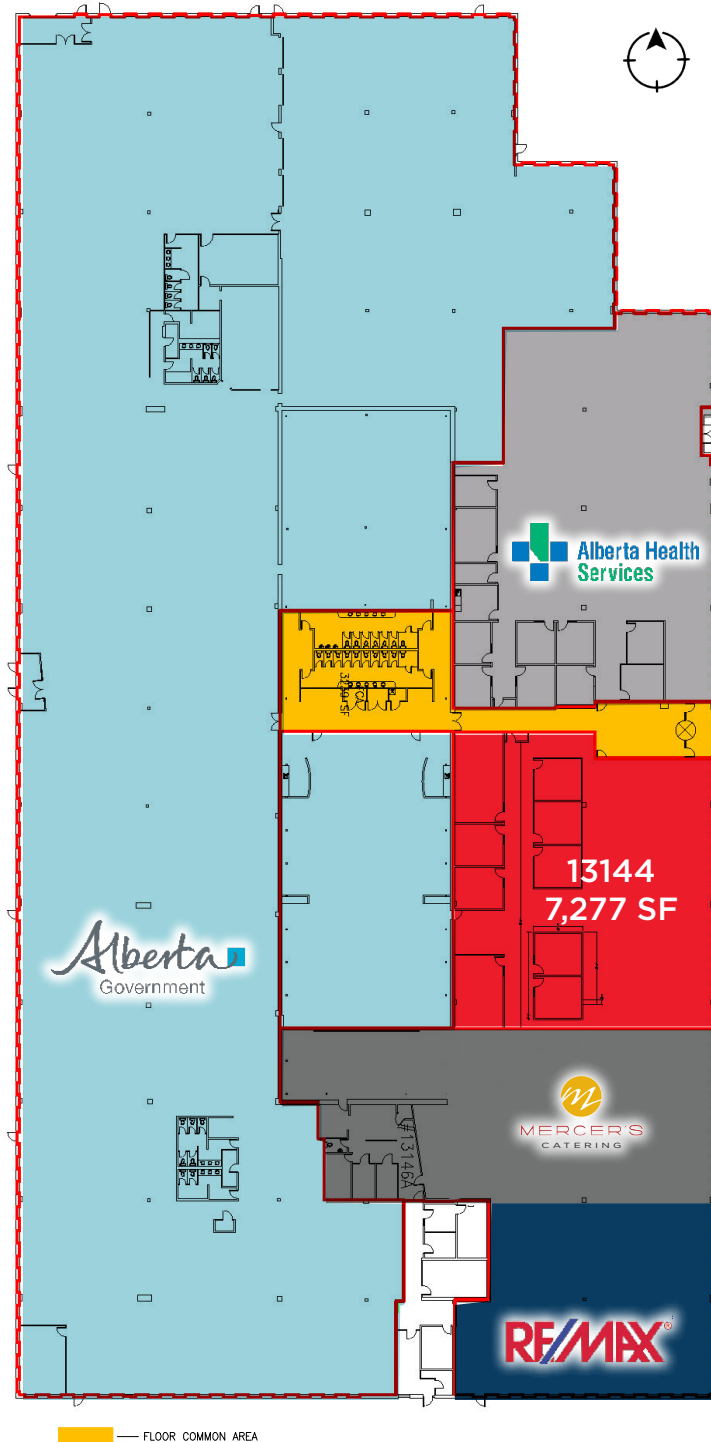

## SITE PHOTOS





# SITE AERIAL



137 AVENUE

## DEMOGRAPHICS



### POPULATION

1km	3km	5km
2,781	39,243	118,810



### HOUSEHOLDS

1km	3km	5km
919	14,593	46,123



### AVERAGE INCOME

1km	3km	5km
\$93,586	\$95,971	\$98,874



### VEHICLES PER DAY

37,000 on St Albert Trail  
in front of property

Cushman & Wakefield Edmonton is independently owned and operated / A Member of the Cushman & Wakefield Alliance. No warranty or representation express or implied is made to the accuracy or completeness of the information contained herein, and same is submitted subject to errors, omissions, change of price, rental or other conditions, withdrawal without notice, and to any special listing conditions imposed by the property owner(s). As applicable, we make no representation as to the condition of the property for properties in question. September 19, 2023

**Nick Mytopher**  
Associate  
587 597 5475  
nick.mytopher@cwedm.com

**Will Harvie**  
Associate Partner  
780 902 4278  
will.harvie@cwedm.com

**Kurt Paull, SIOR**  
Associate Partner  
780 702 4258  
kurt.paull@cwedm.com

**Max McPeak**  
Associate  
780 700 5038  
max.mcpeak@cwedm.com

**CUSHMAN & WAKEFIELD**  
Edmonton