

1,181 - 2,315 SF AVAILABLE IMMEDIATELY

CENTURY PLAZA EDMONTON, AB

FOR LEASE

Century Plaza
11031 97 Street, Edmonton, AB

Jameson Rebeyka

Associate
780 420 1177
jameson.rebeyka@cwedm.com



THE OPPORTUNITY

Cushman and Wakefield Edmonton is pleased to present the opportunity to Lease space in Century Plaza along 97th Street. The building is newly constructed with multiple demising options available. The property features exceptional exposure with large street front windows allowing for great natural light. Strategically located only minutes from the Royal Alexandra hospital.

Ideal Tenants: Professional Services, Nail Salon, Quick Serve Restaurant, Medical Specialist, Daycare, and Dentist

PROPERTY DETAILS

MUNICIPAL ADDRESS

11031 97 Street, Edmonton AB T5H 2H1

LEGAL DESCRIPTION

Lot 24A, Block 35, Plan 1821097

ZONING

CB1 - Low Intensity Business Zone

NEIGHBOURHOOD

Coronet Industrial

BUILDING SIZE

Unit 1: 1,181 SF (±)

Unit 2: 1,134 SF (±)

PARKING

Rear surface parking onsite and surrounding

LEASE RATE

\$22.00 Per SF

OPERATING COST

\$12.50 Per SF

AVAILABILITY

Immediately



SITE PLAN

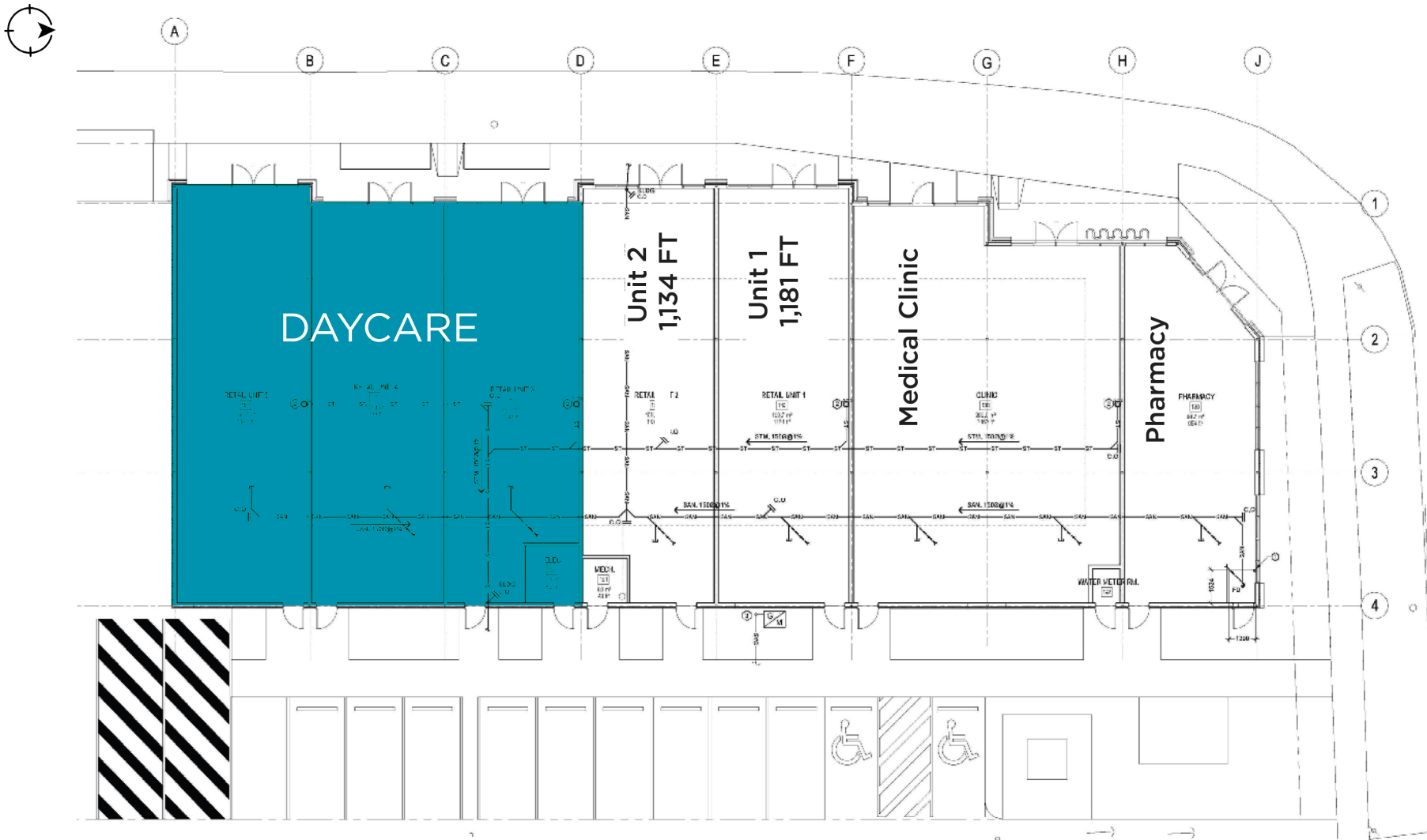

SITE AERIAL



111 AVENUE

SITE

101 STREET

97 STREET

KINGSWAY



Cushman & Wakefield Edmonton is independently owned and operated / A Member of the Cushman & Wakefield Alliance. No warranty or representation express or implied is made to the accuracy or completeness of the information contained herein, and same is submitted subject to errors, omissions, change of price, rental or other conditions, withdrawal without notice, and to any special listing conditions imposed by the property owner(s). As applicable, we make no representation as to the condition of the property for properties in question. January 13, 2023

Jameson Rebeyka

Associate

780 420 1177

jameson.rebeyka@cwedm.com