

HEMINGWAY PLAZA

5232 199 Street, Edmonton, AB

2,276 SF (FORMER VETERINARIAN SPACE)



Dustin Bateyko
Partner
780 702 4257
dustin.bateyko@cwedm.com

Cushman & Wakefield Edmonton is independently owned and operated / A Member of the Cushman & Wakefield Alliance. No warranty or representation, express or implied, is made to the accuracy or completeness of the information contained herein, and same is submitted subject to errors, omissions, change of price, rental or other conditions, withdrawal without notice, and to any special listing conditions imposed by the property owner(s). As applicable, we make no representation as to the condition of the property (or properties) in question. December 22, 2022

CUSHMAN & WAKEFIELD
Edmonton
Suite 2700, TD Tower
10088 - 102 Avenue
Edmonton, AB T5J 2Z1
www.cwedm.com

FLOOR PLAN

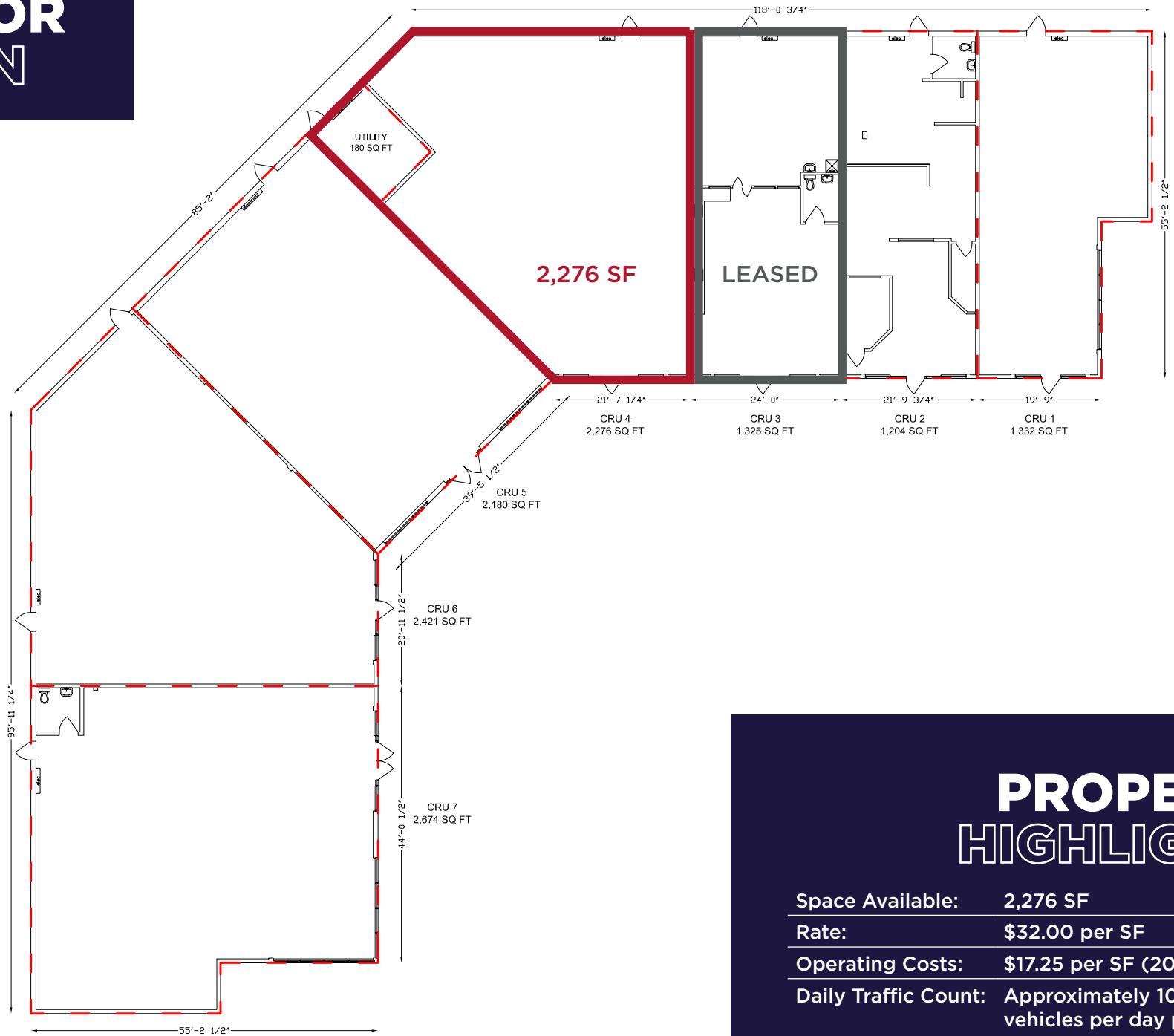

PROPERTY HIGHLIGHTS

Space Available:	2,276 SF
Rate:	\$32.00 per SF
Operating Costs:	\$17.25 per SF (2025)
Daily Traffic Count:	Approximately 10,000 vehicles per day pass the property on 199 Street

AERIAL VIEW



Dustin Bateyko
Partner
780 702 4257
dustin.bateyko@cwedm.com

Cushman & Wakefield Edmonton is independently owned and operated / A Member of the Cushman & Wakefield Alliance. No warranty or representation, express or implied, is made to the accuracy or completeness of the information contained herein, and same is submitted subject to errors, omissions, change of price, rental or other conditions, withdrawal without notice, and to any special listing conditions imposed by the property owner(s). As applicable, we make no representation as to the condition of the property (or properties) in question. December 22, 2022

CUSHMAN & WAKEFIELD
Edmonton
Suite 2700, TD Tower
10088 - 102 Avenue
Edmonton, AB T5J 2Z1
www.cwedm.com