



## 5442 SF Second Floor Office

### Property Highlights

- Professionally managed by Rohit Property Management
- Move-in ready office space with high end finishes
- Furniture is negotiable
- Elevator equipped with a pristine common lobby
- Excellent parking ratio (3.3 stalls per 1,000 SF)
- Great accessibility via 91 Street, Ellerslie Road and Anthony Henday

Another exciting development from:



#### Will Harvie

Associate Partner  
780 902 4278  
will.harvie@cwedm.com

#### Nick Mytopher

Associate  
587 597 5475  
nick.mytopher@cwedm.com

#### Kurt Paull, SIOR

Associate Partner  
780 702 4258  
kurt.paull@cwedm.com

#### Max McPeak

Associate  
780 700 5038  
max.mcpeak@cwedm.com

#### CUSHMAN & WAKEFIELD

**Edmonton**  
Suite 2700, TD Tower  
10088 - 102 Avenue  
Edmonton, AB T5J 2Z1  
[www.cwedm.com](http://www.cwedm.com)

## Property Details

<b>Areas Available:</b>	<b>North Wing</b> 5,442 SF - Unit 212
<b>Zoning:</b>	IB
<b>Lease Rate:</b>	\$16.00 - \$18.00 per SF
<b>Operating Costs:</b>	\$14.35 per SF
<b>Property Management:</b>	5% of Total Rent
<b>Signage:</b>	<b>Pylon</b> \$250.00 per month (full) \$125.00 per month (half)
<b>Parking Ratio:</b>	3.3 per 1,000 SF

## Office Development Ideal For:



### Start-Ups

IT services, psychologists, real estate offices, home builders, etc.



### Professional Associations

Unions, professional associations, not-for-profit associations, commercial schools, etc.



### Professional Services

Accounting firm, law firm, etc.

## Unit 212 Floor Plan

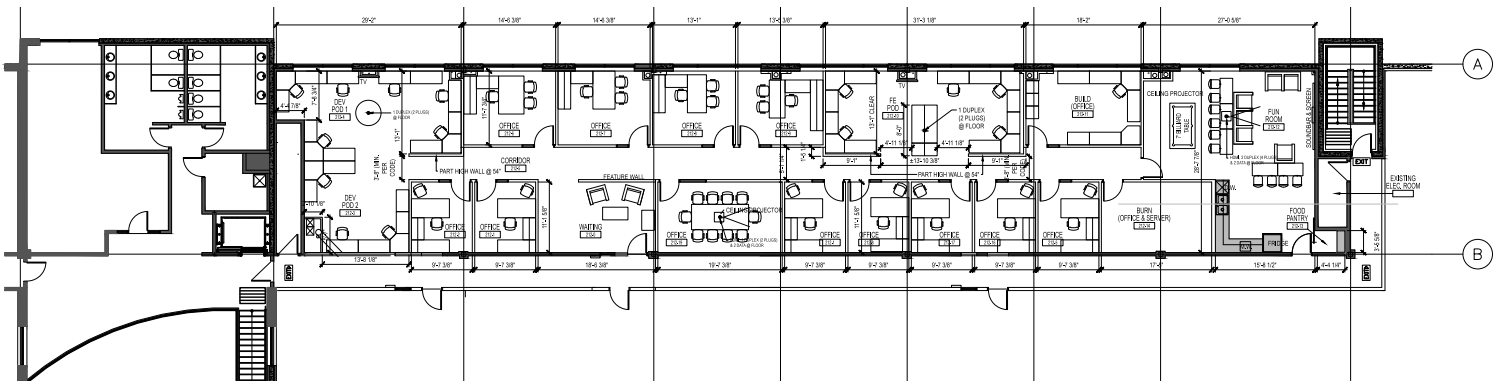

**Will Harvie**  
Associate Partner  
780 902 4278  
will.harvie@cwedm.com

**Nick Mytopher**  
Associate  
587 597 5475  
nick.mytopher@cwedm.com

**Kurt Paull, SIOR**  
Associate Partner  
780 702 4258  
kurt.paull@cwedm.com

**Max McPeak**  
Associate  
780 700 5038  
max.mcpeak@cwedm.com

**CUSHMAN & WAKEFIELD**  
Edmonton  
Suite 2700, TD Tower  
10088 - 102 Avenue  
Edmonton, AB T5J 2Z1  
[www.cwedm.com](http://www.cwedm.com)

**Unit 212 Photos**



**Will Harvie**  
Associate Partner  
780 902 4278  
will.harvie@cwedm.com

**Nick Mytopher**  
Associate  
587 597 5475  
nick.mytopher@cwedm.com

**Kurt Paull, SIOR**  
Associate Partner  
780 702 4258  
kurt.paull@cwedm.com

**Max McPeak**  
Associate  
780 700 5038  
max.mcpeak@cwedm.com

**CUSHMAN & WAKEFIELD**  
Edmonton  
Suite 2700, TD Tower  
10088 - 102 Avenue  
Edmonton, AB T5J 2Z1  
[www.cwedm.com](http://www.cwedm.com)

AERIAL



SITE



**CUSHMAN &  
WAKEFIELD**  
Edmonton

**Will Harvie**

Associate Partner  
780 902 4278

[will.harvie@cwedm.com](mailto:will.harvie@cwedm.com)

**Nick Mytopher**

Associate  
587 597 5475

[nick.mytopher@cwedm.com](mailto:nick.mytopher@cwedm.com)

**Kurt Paull, SIOR**

Associate Partner  
780 702 4258

[kurt.paull@cwedm.com](mailto:kurt.paull@cwedm.com)

**Max McPeak**

Associate  
780 700 5038

[max.mcpeak@cwedm.com](mailto:max.mcpeak@cwedm.com)